



9 Chapel Lane, Stockton Heath, Warrington, Cheshire, WA4 6LL

£1,100 PCM



9 Chapel Lane, Stockton Heath, Warrington, Cheshire, WA4 6LL

£1,100 PCM

**** VIEWINGS CLOSED ****

**** IT'S ABOUT LOCATION, LOCATION, LOCATION! **** This lovely property which was previously extended to the rear and finished to a high standard, is located in a prime position. Situated in the heart of Stockton Heath village, therefore being seconds walk to all the village amenities and the added bonus of Warrington town centre being approximately 2 miles away and the M56 motorway network is approximately 3 miles away also. Property comprises: Living room, large dining area which leads to a stunning kitchen with integrated appliances and patio doors leading to a nice sized easily maintainable garden. To the first floor will be found 2 double bedrooms and a bathroom with shower over bath. The property benefits from gas central heating, double glazing. Available end of February. UNFURNISHED.

Description



Unfurnished
Council Tax Band: A
Available: 26th July 2024

Floor Plans

Chapel Lane, Stockton Heath

Approximate Gross Internal Area :-
 Ground Floor :- 40.27 sq m / 434 sq ft
 First Floor :- 33.37 sq m / 359 sq ft
 Total :- 73.64 sq m / 793 sq ft

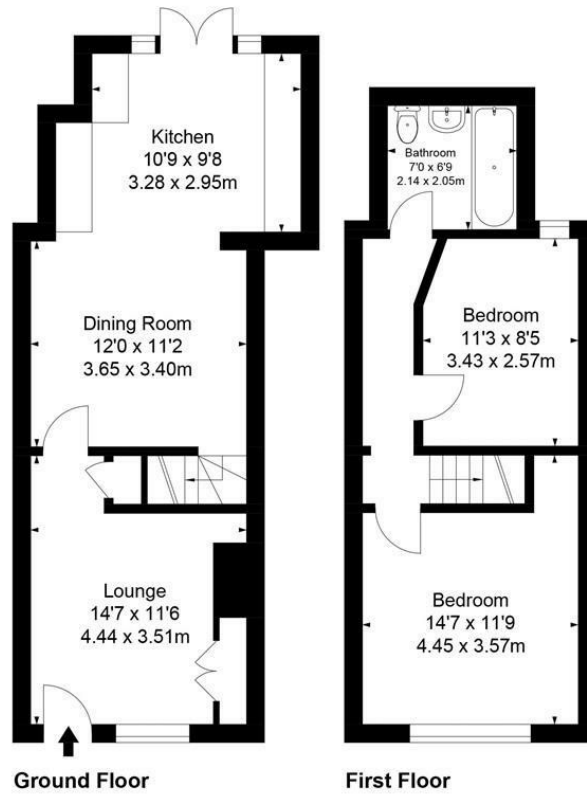

Whilst every effort is made to accurately reproduce these floor plans, measurements are approximate, not to scale and for illustrative purposes only

Area Map

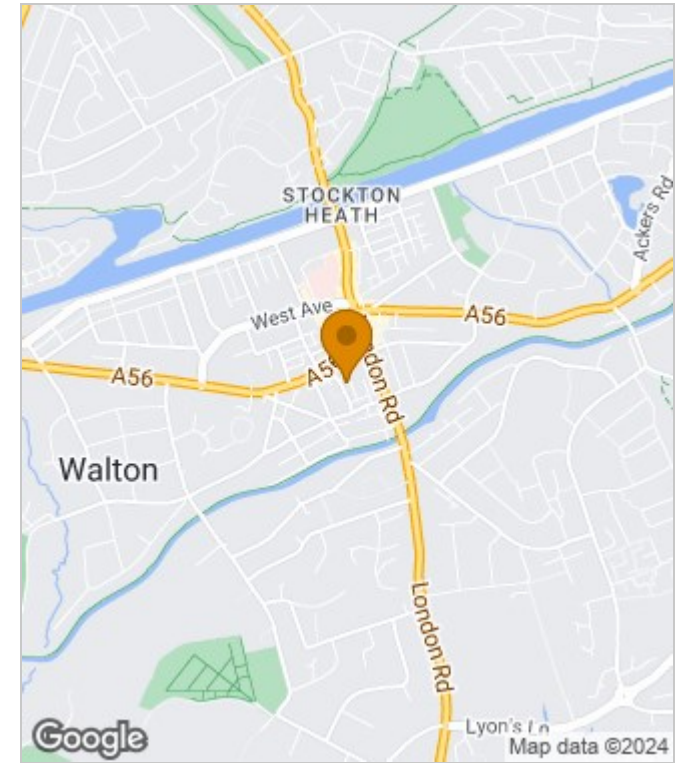

Energy Performance Graph

| Energy Efficiency Rating | | Current | Potential |
|---|-------------------------|---------|-----------|
| Very energy efficient - lower running costs | | | |
| (92 plus) A | | | |
| (81-91) B | | | |
| (69-80) C | | | |
| (55-68) D | | | |
| (39-54) E | | | |
| (21-38) F | | | |
| (1-20) G | | | |
| Not energy efficient - higher running costs | | | |
| England & Wales | EU Directive 2002/91/EC | | |

These particulars, whilst believed to be accurate are set out as a general outline only for guidance and do not constitute any part of an offer or contract. Intending purchasers should not rely on them as statements of representation of fact, but must satisfy themselves by inspection or otherwise as to their accuracy. No person in this firm's employment has the authority to make or give any representation or warranty in respect of the property.