



93 Higher Lane, Lymm, WA13 0BZ

£995,000



93 Higher Lane, Lymm, WA13 0BZ

£995,000

Welcome to this stunning property located on Higher Lane in the picturesque village of Lymm comprising over 2,600 sq.ft. This beautiful house boasts 3 reception rooms, a spacious master bedroom with ensuite bathroom, 4 further bedrooms, and 3 modern bathrooms, offering ample space for a growing family or those who love to entertain.

As you step inside, you are greeted by the character and charm that this property exudes. The large kitchen, complete with a dining area, is perfect for hosting family meals or dinner parties with friends. The mature garden provides a peaceful retreat where you can relax and unwind after a long day.

Parking is made easy with a driveway that can accommodate several vehicles, ensuring you never have to worry about finding a spot on the street. The property's location on Higher Lane offers a sense of tranquillity while still being conveniently located near local amenities and schools.

Don't miss the opportunity to make this house your home and enjoy the perfect blend of comfort, style, and space. Contact us today to arrange a viewing and experience the magic of this wonderful property in Lymm.

Description



null

Council Tax Band: G

Available:

Floor Plans

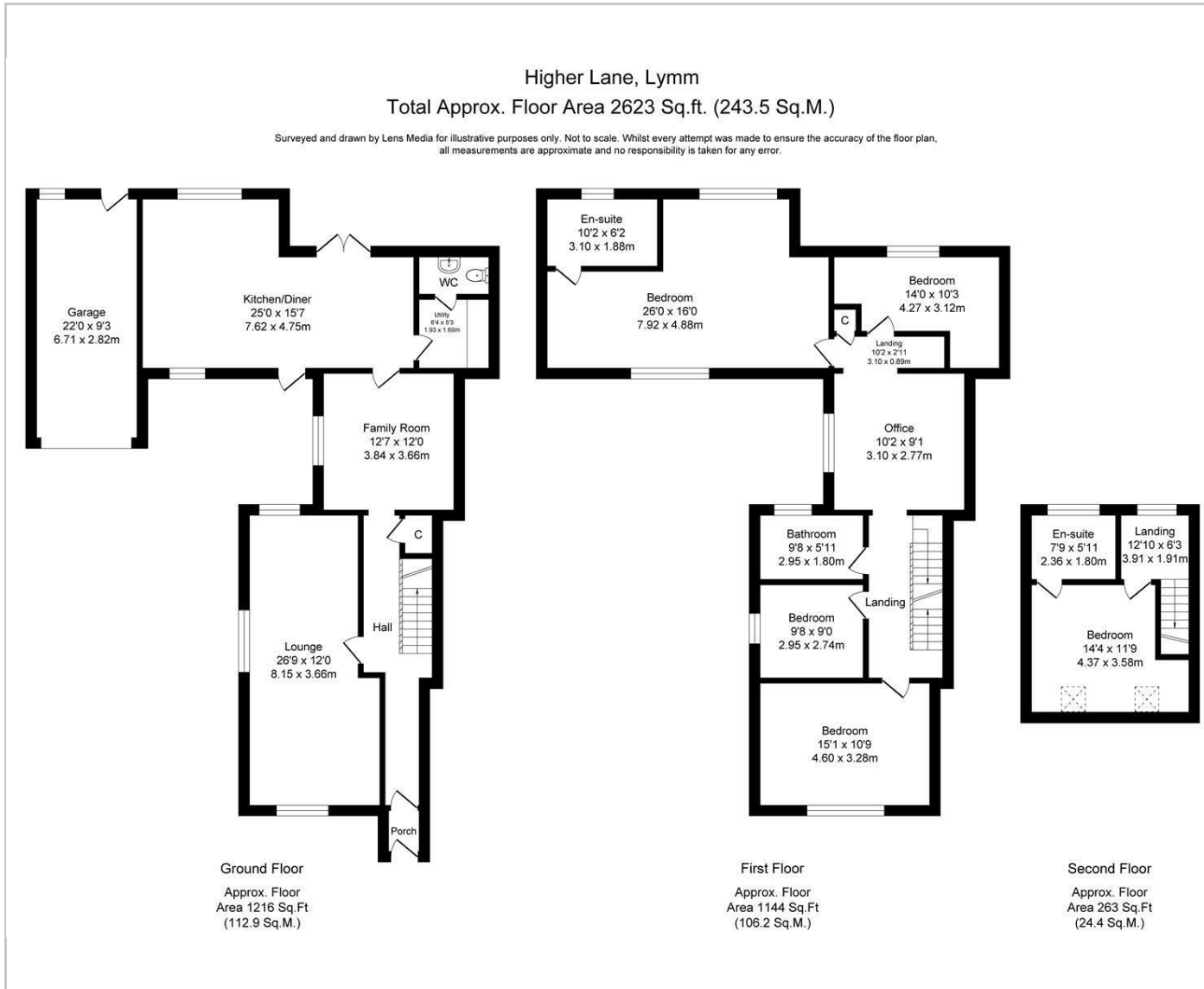

Area Map



Energy Performance Graph

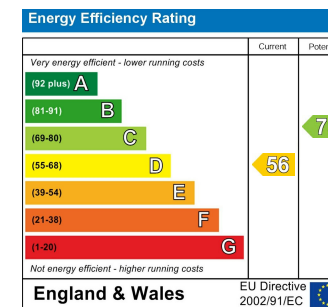

These particulars, whilst believed to be accurate are set out as a general outline only for guidance and do not constitute any part of an offer or contract. Intending purchasers should not rely on them as statements of representation of fact, but must satisfy themselves by inspection or otherwise as to their accuracy. No person in this firm's employment has the authority to make or give any representation or warranty in respect of the property.