



5 Grasmere Road, Lymm, Cheshire, WA13 9PL

£330,000



5 Grasmere Road, Lymm, Cheshire, WA13 9PL

£330,000

A semi detached house situated in a great location within walking distance of Lymm village centre. The well maintained and recently decorated property comprises a porch, hallway, cloakroom/wc, lounge through to dining area and kitchen. There is also a conservatory. Upstairs there are three good size bedrooms and a recently refitted bathroom. Externally there is a long driveway and lawned front garden and to the rear there is a lawn, patio and borders.

## Description

A semi detached house situated in a great location within walking distance of Lymm village centre. The well maintained property comprises a porch, hallway, cloakroom/wc, lounge through to dining area and kitchen. There is also a conservatory. Upstairs there are three good size bedrooms and a wet room. Externally there is a long driveway and lawned front garden and to the rear there is a lawn, patio and borders.



null

Council Tax Band: C

Available:

## Floor Plans

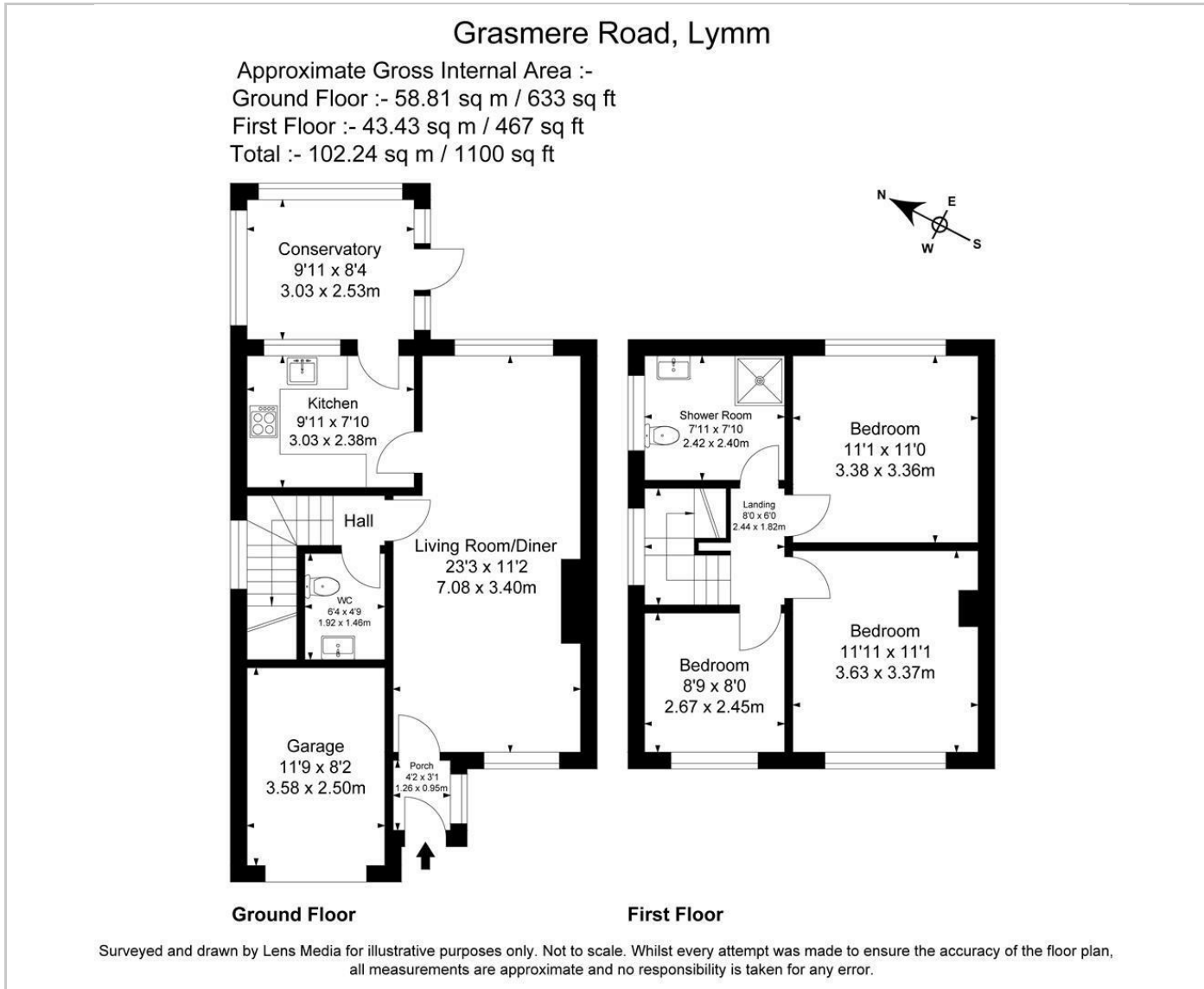

## Area Map

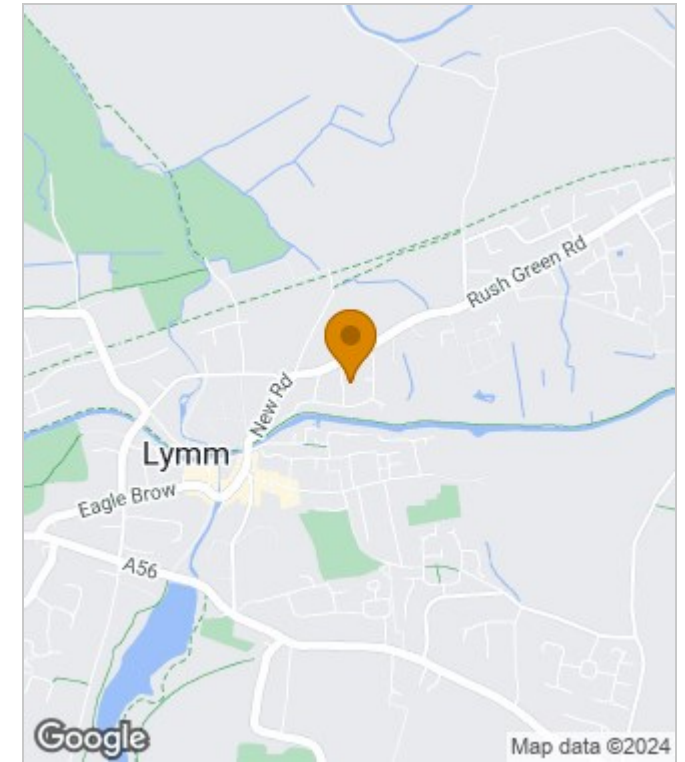

## Energy Performance Graph

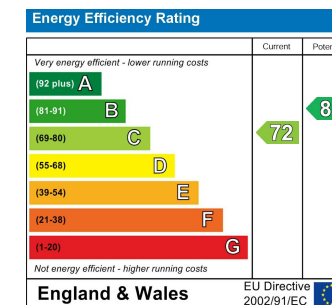

These particulars, whilst believed to be accurate are set out as a general outline only for guidance and do not constitute any part of an offer or contract. Intending purchasers should not rely on them as statements of representation of fact, but must satisfy themselves by inspection or otherwise as to their accuracy. No person in this firm's employment has the authority to make or give any representation or warranty in respect of the property.