

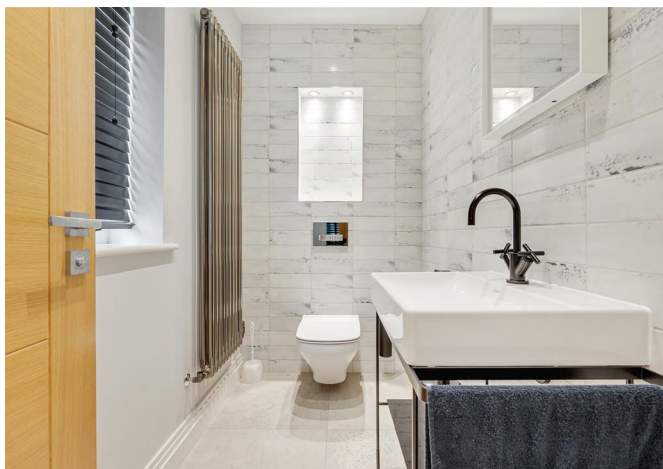

19 Goose Lane, Hatton, Warrington, Cheshire, WA4 5PA

£525,000



## 19 Goose Lane, Hatton, Warrington, Cheshire, WA4 5PA

£525,000

Welcome to this charming property with stunning views located on Goose Lane in the picturesque, rural village of Hatton. This delightful house boasts a spacious openplan layout to the ground floor with a modern fitted kitchen with central island, open into the dining room / Living room, the bifold doors give access to the beautifully landscaped garden, there is a handy utility room and WC. To the first floor there are two double bedrooms, an office room and a stylish family bathroom, on the second floor you will find a great sized master bedroom with Juliette balcony overlooking the fields and an ensuite shower room. Situated in a peaceful, rural village, this house offers a tranquil escape from the hustle and bustle of everyday life, yet giving great access to motorways and a short drive from Stockton Heath center where you will find bars, shops and restaurants. Don't miss the opportunity to make this house your home, with its inviting atmosphere and desirable location. Contact us today to arrange a viewing.

## Description



null  
Council Tax Band: C  
Available:

## Floor Plans

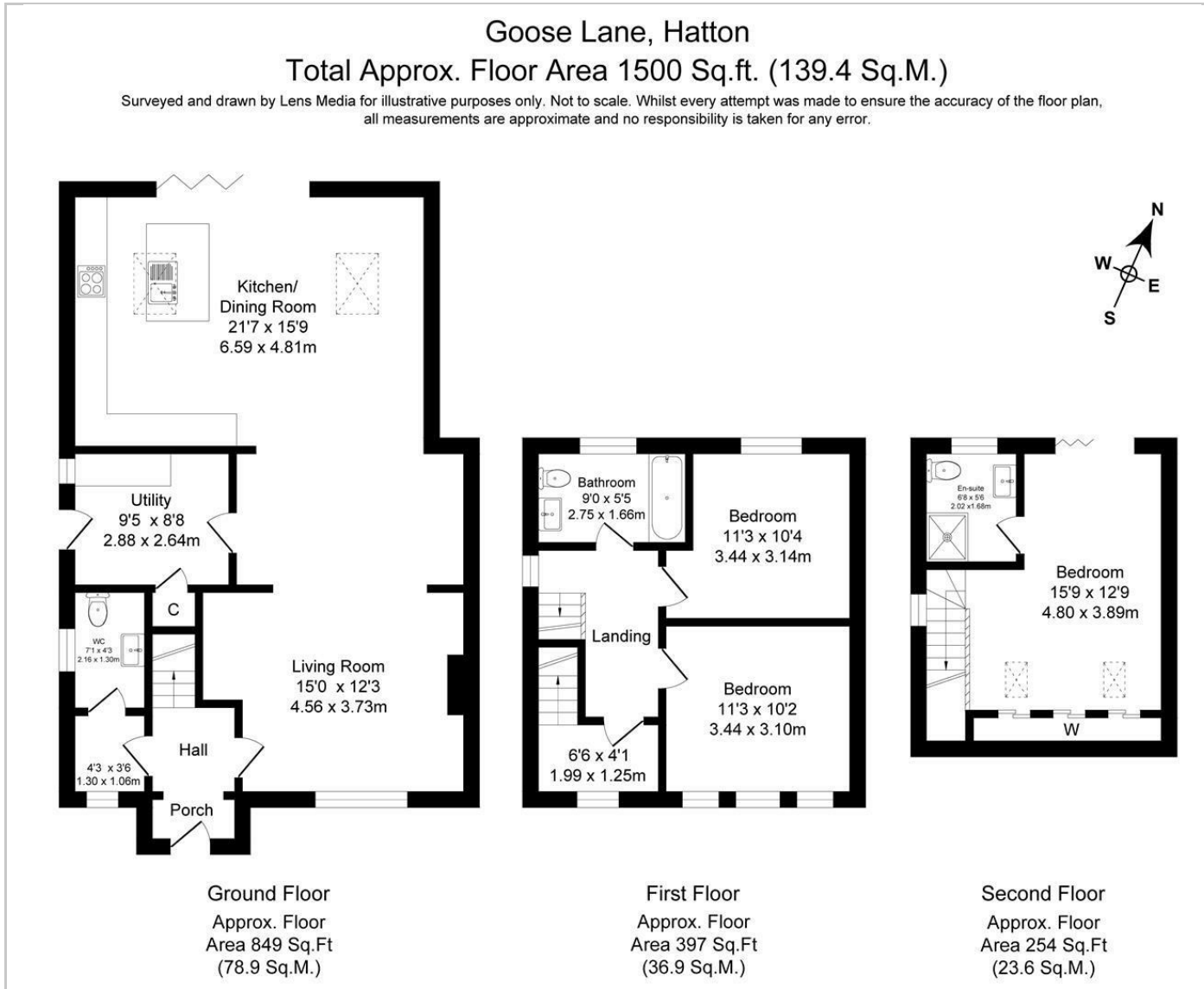

## Area Map



## Energy Performance Graph

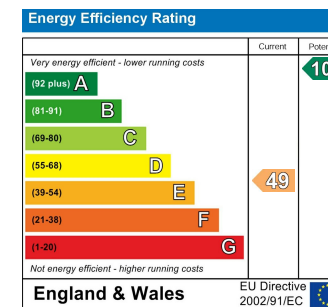

These particulars, whilst believed to be accurate are set out as a general outline only for guidance and do not constitute any part of an offer or contract. Intending purchasers should not rely on them as statements of representation of fact, but must satisfy themselves by inspection or otherwise as to their accuracy. No person in this firm's employment has the authority to make or give any representation or warranty in respect of the property.