



3 Dingle Bank Close, Lymm, Cheshire, WA13 0QR

£749,999



3 Dingle Bank Close, Lymm, Cheshire, WA13 0QR

£749,999

A fantastic opportunity to purchase a 2200sqft detached property with 4 double bedrooms, situated a few minutes' walk from both Lymm village centre and Lymm dam.

The property comprises hallway, good sized study, downstairs cloak room WC, large living room with glass doors into the dining room which gives access to the garden through patio doors, a further sitting room / morning room with floor to ceiling windows looks out over the garden.

A modern fitted kitchen and handy utility room. The first floor has a galleried landing giving access to a master with ensuite shower room, three further double bedrooms and a family bathroom. Externally there is a long driveway with parking for multiple vehicles, double garage and a pretty front garden. There is a beautifully maintained rear garden with matured shrubs and paved with Indian stone that gives a Mediterranean feel, perfect for outdoor living and entertaining. This property offers huge potential and would be a perfect family home.

Description



Situation



null

Council Tax Band: G

Available:

Floor Plans

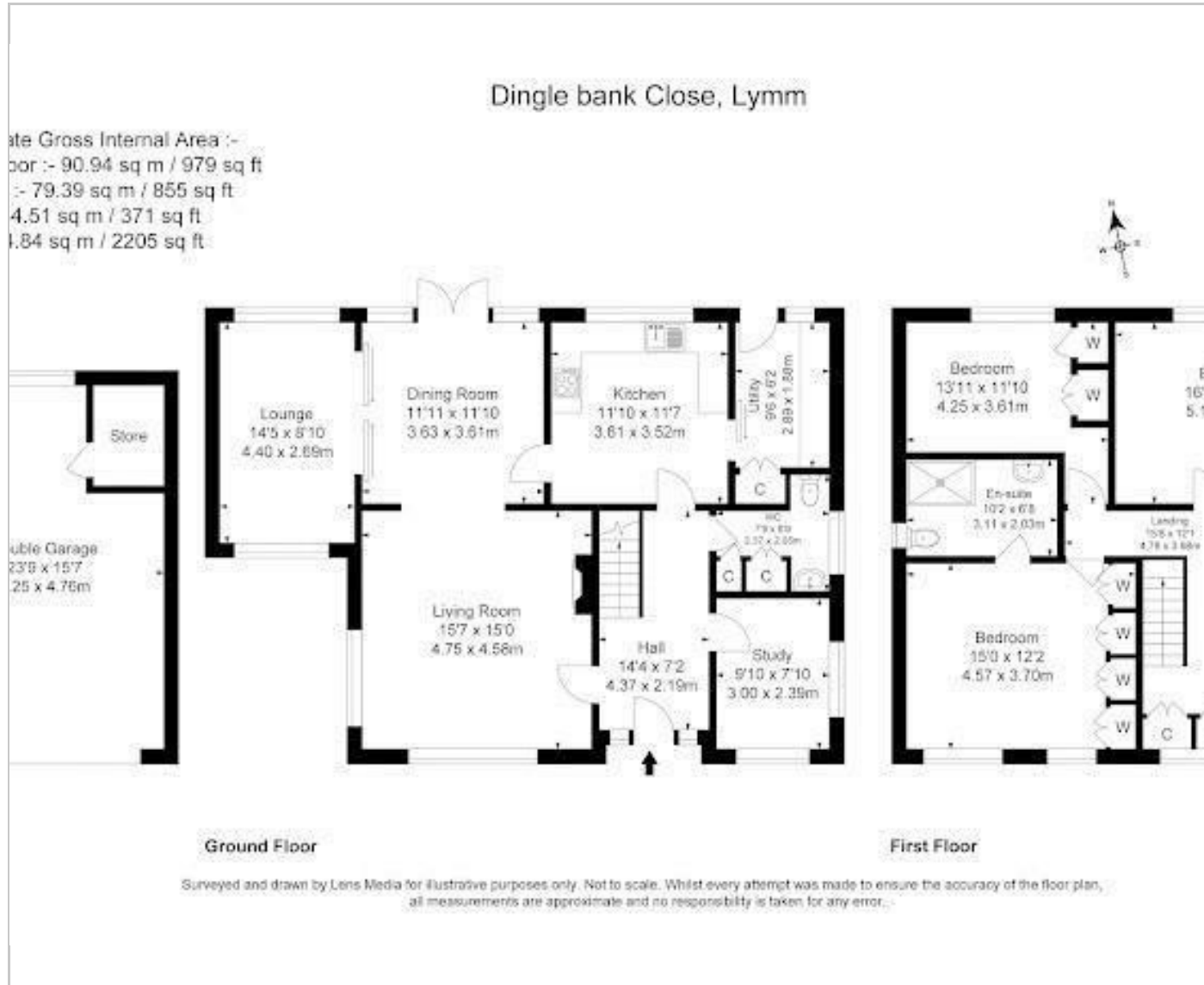

Area Map

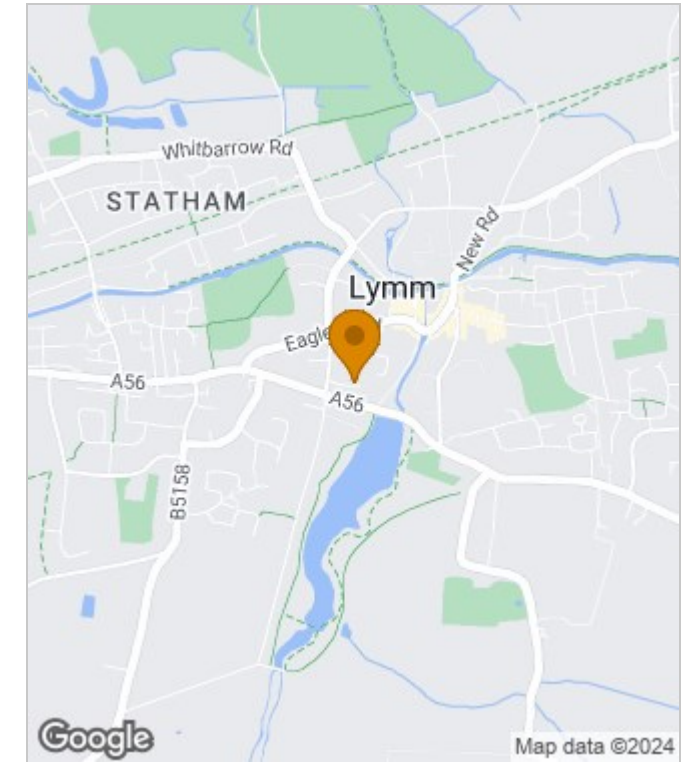

Energy Performance Graph

Energy Efficiency Rating		Current	Potential
Very energy efficient - lower running costs			
(92 plus) A			
(81-91) B			
(69-80) C			
(55-68) D			
(39-54) E			
(21-38) F			
(1-20) G			
Not energy efficient - higher running costs			
England & Wales	EU Directive 2002/91/EC		

These particulars, whilst believed to be accurate are set out as a general outline only for guidance and do not constitute any part of an offer or contract. Intending purchasers should not rely on them as statements of representation of fact, but must satisfy themselves by inspection or otherwise as to their accuracy. No person in this firm's employment has the authority to make or give any representation or warranty in respect of the property.