



Flat 1, Old Church Street 40 Weaste Lane, Salford, Manchester, Greater Manchester, M5 5HL

£875 PCM



Flat 1, Old Church Street 40 Weaste Lane, Salford, Manchester, Greater
Manchester, M5 5HU
£875 PCM

A two bedroom ground floor apartment located in a fantastic development located just off Eccles New Road. Old Church Court is situated just a 10 minute drive from the city centre and 1 minute walk away from the Metrolink network offering superb access to and from the City Centre and Salford Quays in just minutes. The property consists of a private entrance hall, SPACIOUS open plan living room which incorporates a fully fitted kitchen with integrated appliances, two double bedrooms and a bathroom with shower over bath. The property benefits from a parking space. SORRY NO PETS, NO SMOKERS Available From 3th June 2024

Description



Situation



Part furnished

Council Tax Band:

Available: 3rd June 2024

Floor Plans

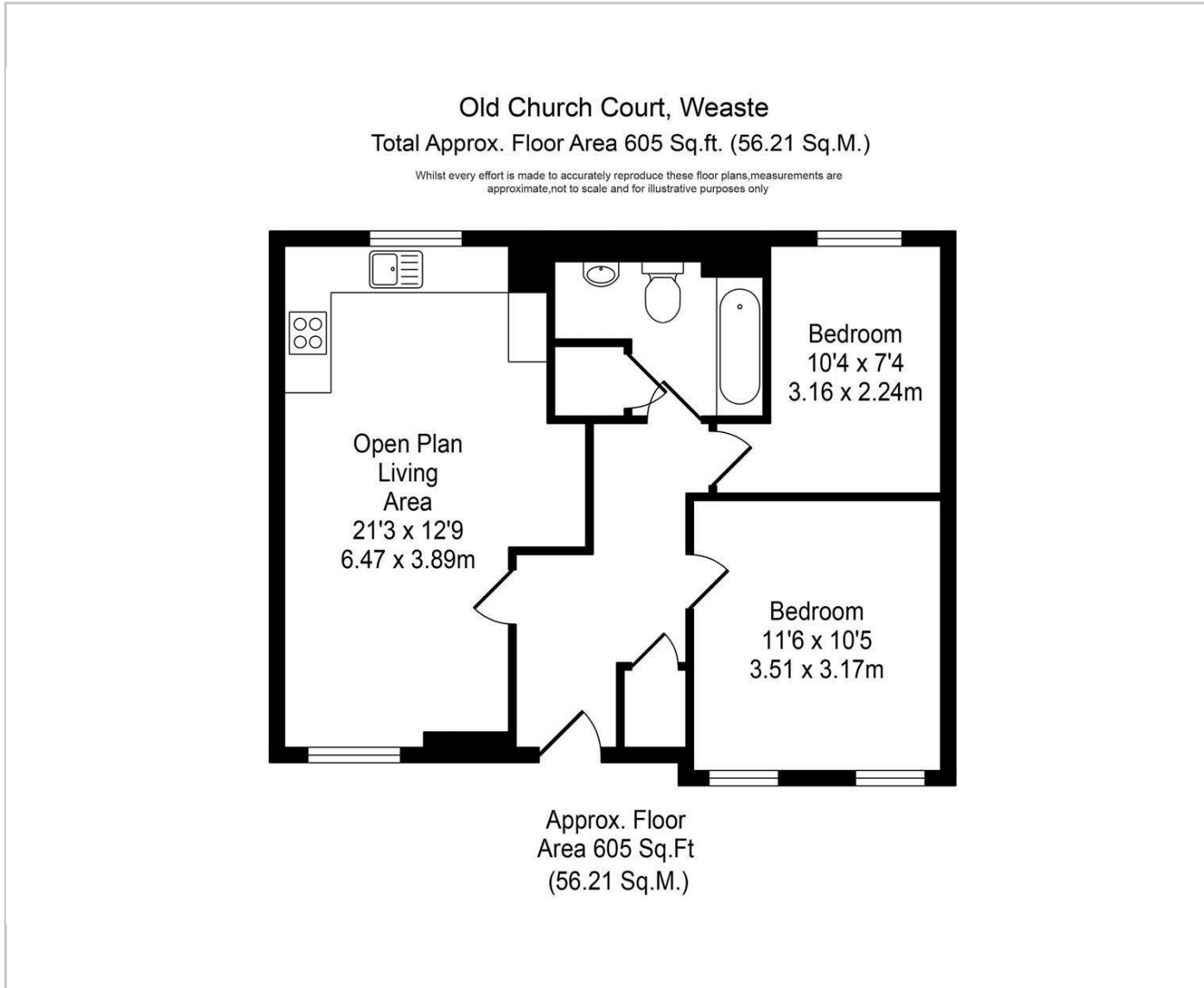

Area Map

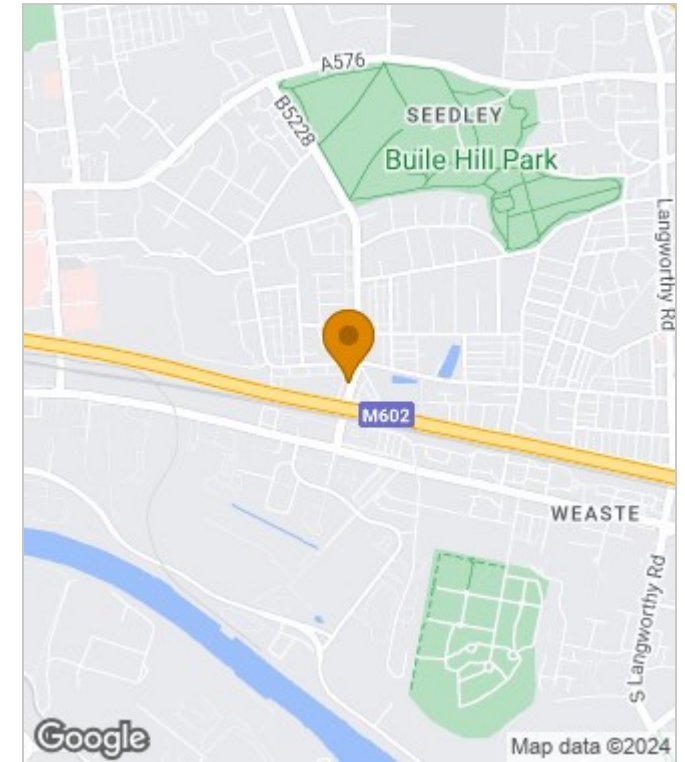

Energy Performance Graph

Energy Efficiency Rating		Current	Potential
Very energy efficient - lower running costs			
(92 plus) A			
(81-91) B			
(69-80) C			
(55-68) D			
(39-54) E			
(21-38) F			
(1-20) G			
Not energy efficient - higher running costs			
England & Wales	EU Directive 2002/91/EC		

These particulars, whilst believed to be accurate are set out as a general outline only for guidance and do not constitute any part of an offer or contract. Intending purchasers should not rely on them as statements of representation of fact, but must satisfy themselves by inspection or otherwise as to their accuracy. No person in this firm's employment has the authority to make or give any representation or warranty in respect of the property.