



137 Lovely Lane, Warrington, Cheshire, WA5 1UB  
**£850 Per Month**



137 Lovely Lane, Warrington, Cheshire, WA5 1UB

£850 Per Month

COMMERCIAL PREMISES. Ground floor commercial unit to rent it is 772sq ft in size and located on a busy link road in Warrington. Available Immediately

## Description



## Situation



Not specified  
Council Tax Band:  
Available: 1st May 2024

## Floor Plans

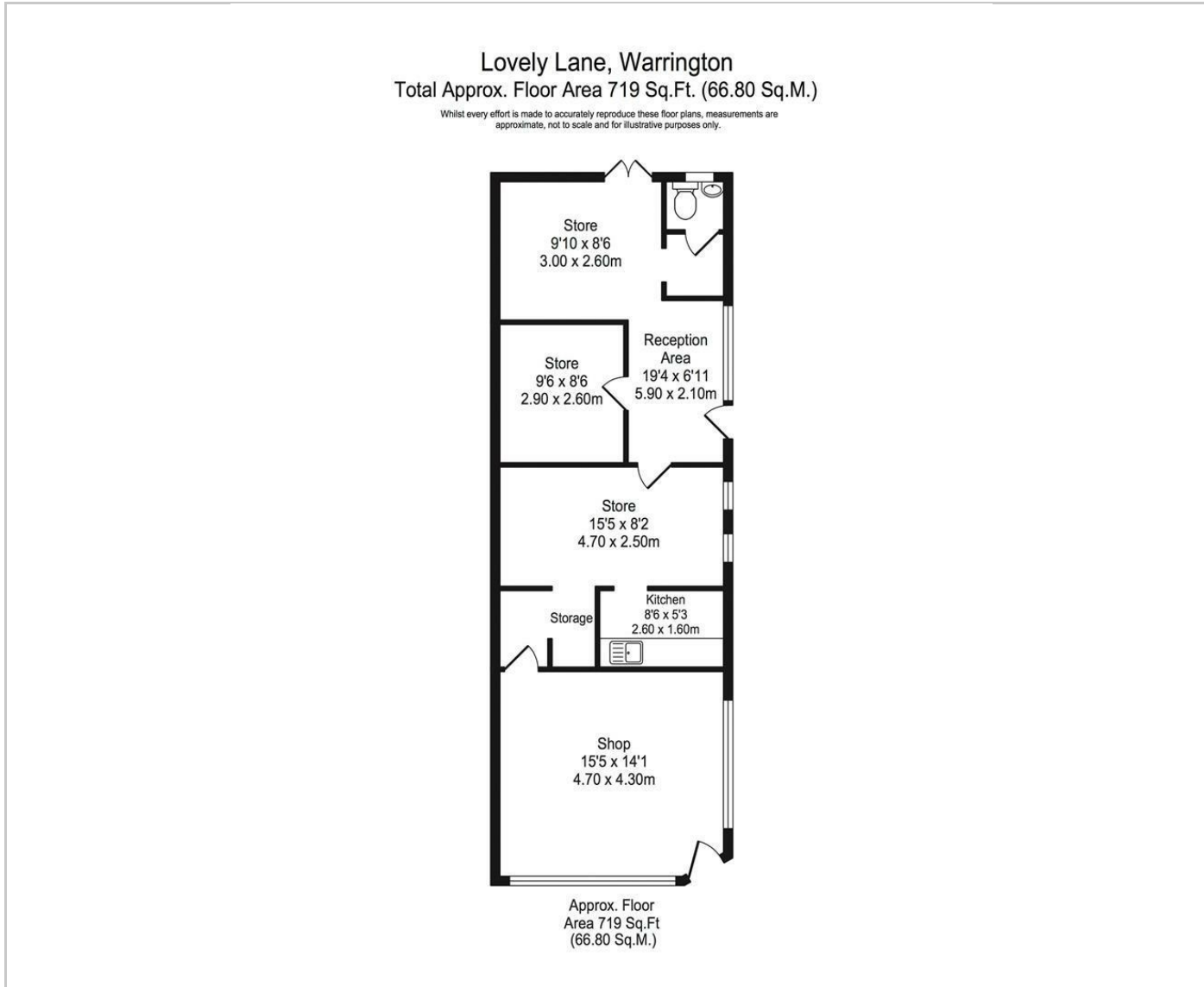

## Area Map

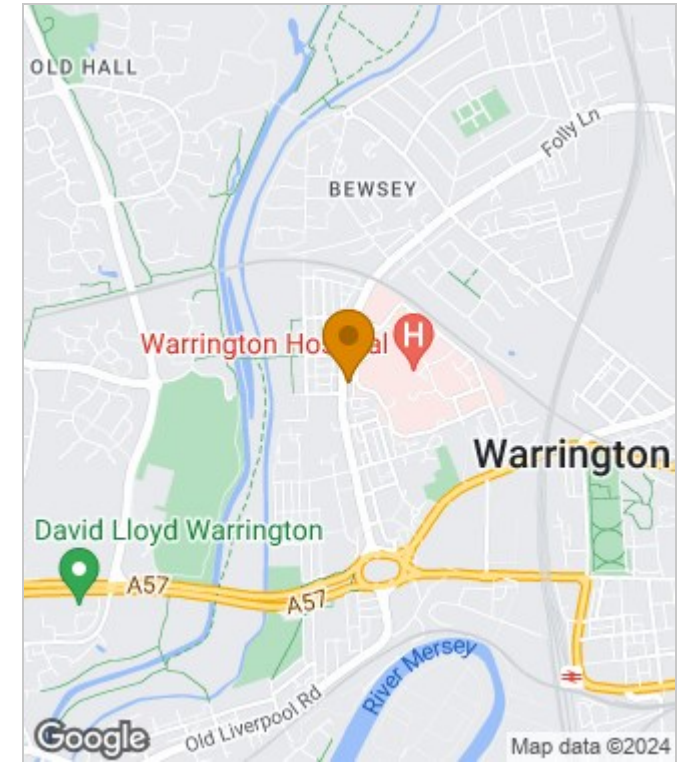

## Energy Performance Graph

Energy Efficiency Rating		Current	Potential
Very energy efficient - lower running costs			
(92 plus) <b>A</b>			
(81-91) <b>B</b>			
(69-80) <b>C</b>			
(55-68) <b>D</b>			
(39-54) <b>E</b>			
(21-38) <b>F</b>			
(1-20) <b>G</b>			
Not energy efficient - higher running costs			
<b>England &amp; Wales</b>	EU Directive 2002/91/EC		

These particulars, whilst believed to be accurate are set out as a general outline only for guidance and do not constitute any part of an offer or contract. Intending purchasers should not rely on them as statements of representation of fact, but must satisfy themselves by inspection or otherwise as to their accuracy. No person in this firm's employment has the authority to make or give any representation or warranty in respect of the property.