



108 Whitbarrow Road, Lymm, WA13 9BB

£295,000



108 Whitbarrow Road, Lymm, WA13 9BB

£295,000

A charming cosy cottage, with off road parking a private rear garden , full of original period features. The property is approached from a cobbled pathway, leading to an entrance porch, a cosy living room with exposed brick and log burning fire , slate flooring runs through out the ground floor , there is a modern fitted kitchen and conservatory / sunroom with bi folding doors on to the rear garden, upstairs there are two bedrooms one good sized double and a single bedroom / office and a modern shower room. Outside there is a patio area, enclosed private garden, and a large shed for storage. The cottage is a perfect location with a near by park , and a 5 minute walk to the Transpenine trail and the bridgewater canal.

Description



Situation



null

Council Tax Band:

Available:

Floor Plans

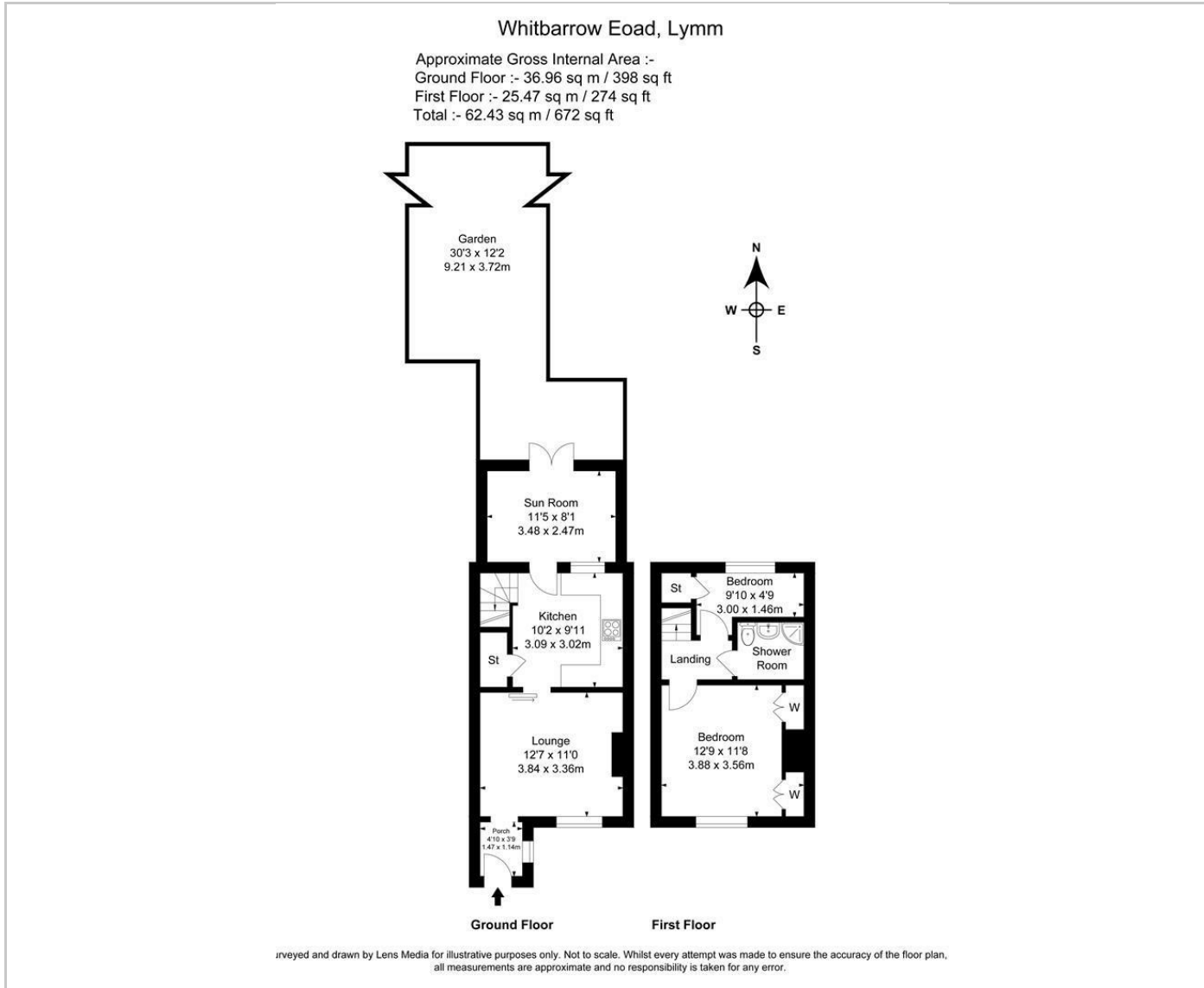

Area Map

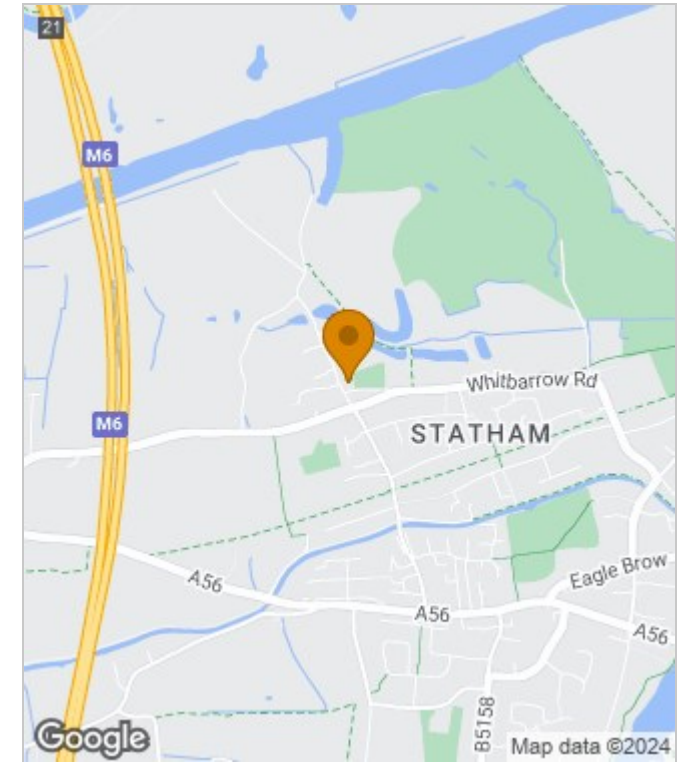

Energy Performance Graph

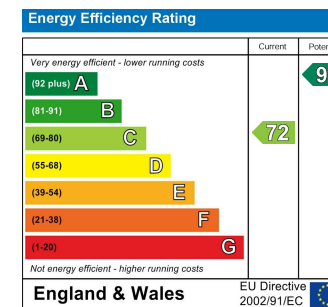

These particulars, whilst believed to be accurate are set out as a general outline only for guidance and do not constitute any part of an offer or contract. Intending purchasers should not rely on them as statements of representation of fact, but must satisfy themselves by inspection or otherwise as to their accuracy. No person in this firm's employment has the authority to make or give any representation or warranty in respect of the property.