



Marlborough Road, N19 4NB

£450,000
Leasehold



Marlborough Road

£450,000

Leasehold

This delightful Victorian conversion flat features 478 square feet of living space, complemented by a lovely private garden to the rear. It includes a large double bedroom with period features, family bathroom, and a contemporary kitchen / open plan reception room with direct access to the garden.

Marlborough Road is a sort-after residential street, ideally situated a brief stroll from Archway Underground Station (Northern Line), Upper Holloway Overground Station, and the green spaces of Whittington Park, Waterlow Park, and Parliament Hill. Additionally, the area offers an abundance of local shops, bars, restaurants and other amenities.

- 478 sqft / 44.4sqm
- Private garden
- Large reception room
- Spacious double bedroom
- Period conversion
- Good transport links
- Chain free
- Long lease (150 Years)







Marlborough Road, N19

Approximate Gross Internal Area = 478 sq ft / 44.4 sq m

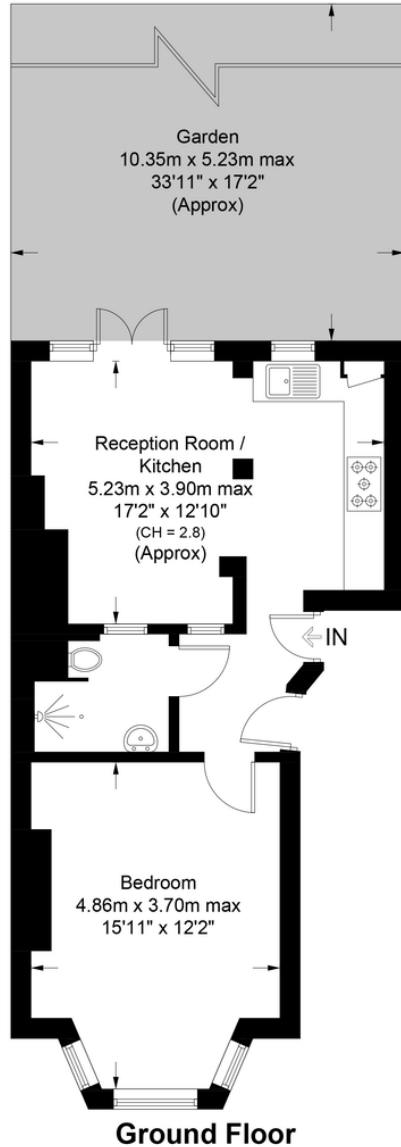

This plan is for layout guidance only. Not drawn to scale unless stated. Windows and door openings are approximate. Whilst every care is taken in the preparation of this plan, please check all dimensions, shapes and compass bearings before making any decisions reliant upon them. (ID1123914)



Certified Property Measurer

DA

DAVID ANDREW your most valuable asset

DAVID ANDREW

your most valuable asset

Archway Office

671 Holloway Road
London, N19 5SE

T (0)20 7619 3750

Highbury Office

90 Highbury Park
London N5 2XE

T (0)20 7354 9111

Stroud Green Office

167 Stroud Green Road
London N4 3PZ

T (0)20 7281 2000

General Contact

E info@davidandrew.co.uk

W www.davidandrew.co.uk

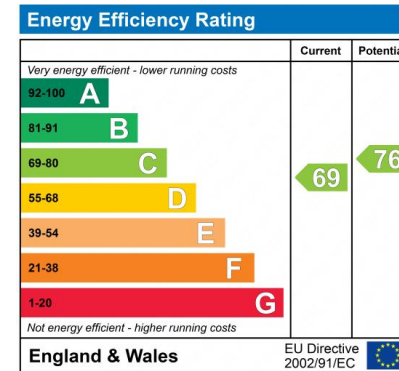

Agent's Note:

Whilst Care has been exercised in the preparation of these sales particulars, statements about the property must not be relied upon as representations of statements or fact. Prospective purchasers must make and rely upon their own enquiries and those of professional representatives. The company accept not liability for any error contained in these particulars.

