



OAKFIELD



Old Farm Road, Bexhill-On-Sea TN39 4DN

Guide Price £525,000





## Old Farm Road, Bexhill- On-Sea TN39 4DN

Nestled in the heart of central Bexhill, Old Farm Road offers a charming three-bedroom detached house on a quiet no-through road. This inviting property features a spacious lounge, a formal dining room, and a dedicated study, perfect for remote work or personal projects. The well-appointed kitchen is separate and leads to a bright conservatory, ideal for relaxing and enjoying views of the private rear garden.

The house boasts three double bedrooms, with the master bedroom benefiting from an en-suite bathroom for added convenience. A family bathroom serves the other two bedrooms. Additional amenities include an integral garage and a driveway with space for up to three cars. Combining comfort, privacy, and a prime location, this home is perfect for families seeking a peaceful retreat with easy access to the amenities of central Bexhill.







### Kitchen

15'5 x 10'6 (4.70m x 3.20m)

### Dining Room

12'11 x 10'7 (3.94m x 3.23m)

### Study

12'8 x 7'9 (3.86m x 2.36m)

### Sitting Room

17'4 x 12'10 (5.28m x 3.91m)

### Conservatory

19'6 x 7'10 (5.94m x 2.39m)

### Bedroom

14'8 x 10'5 (4.47m x 3.18m)

### Bedroom

10'10 x 8'11 (3.30m x 2.72m)

### Bedroom

11'6 x 10'10 (3.51m x 3.30m)

### Garage

16'11 x 9'2 (5.16m x 2.79m)

Council Tax Band - E £2,982 per annum



## Floor Plan

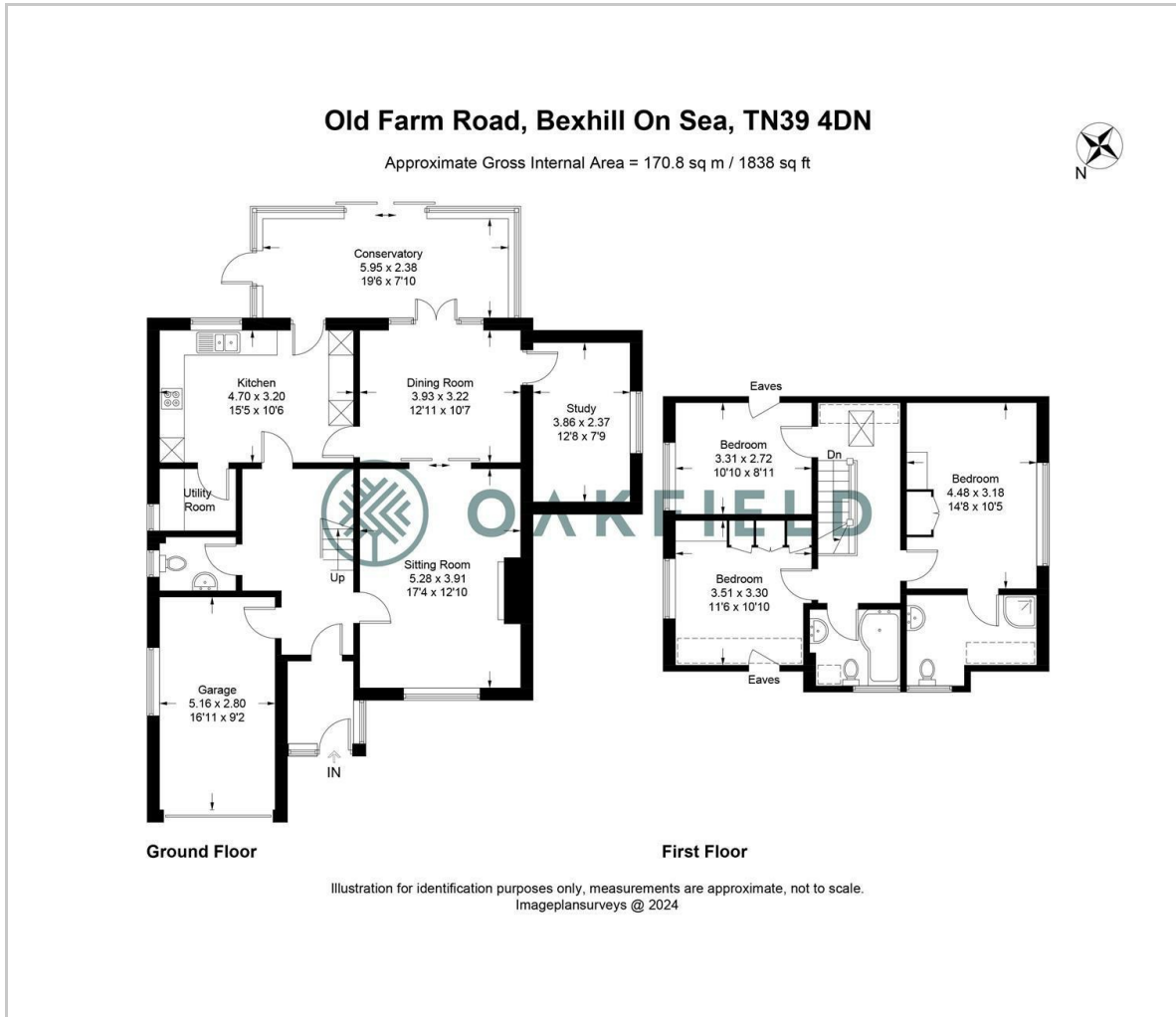

## Viewing

Please contact us on 01424 224700 if you wish to arrange a viewing appointment for this property or require further information.

These particulars, whilst believed to be accurate are set out as a general outline only for guidance and do not constitute any part of an offer or contract. Intending purchasers should not rely on them as statements of representation of fact, but must satisfy themselves by inspection or otherwise as to their accuracy. No person in this firm's employment has the authority to make or give any representation or warranty in respect of the property.

## Area Map

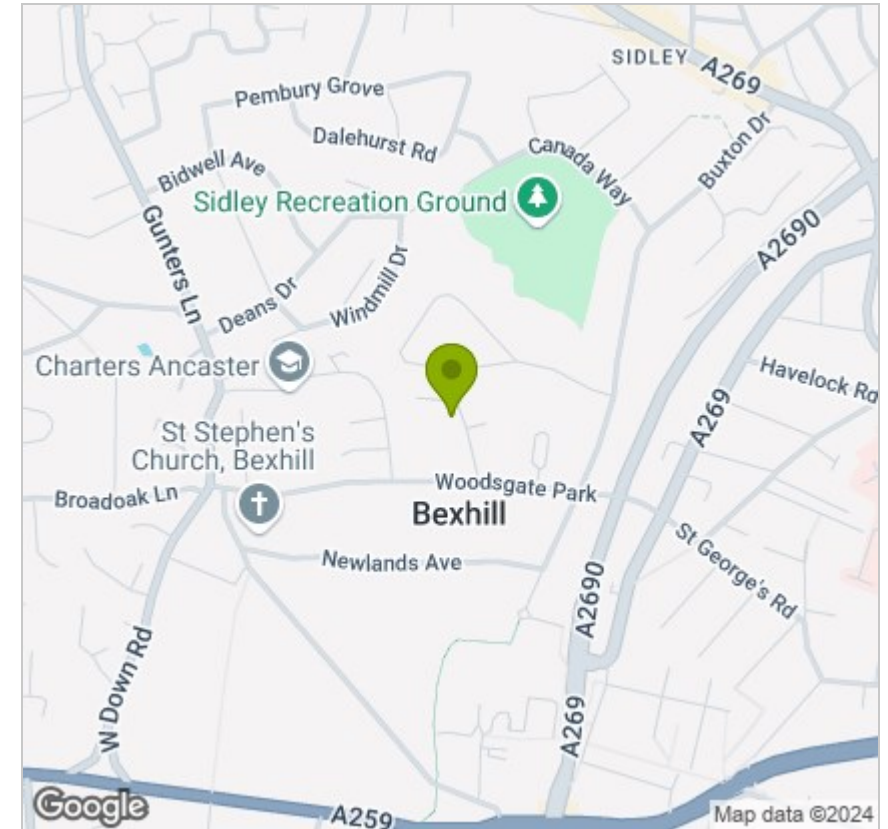

## Energy Efficiency Graph

