



OAKFIELD



Fairmount Road, Bexhill-On-Sea

Offers In Excess Of £200,000



2



1



1



C



## Fairmount Road, Bexhill-On-Sea

Welcome to Adhesive Lodge, a charming 2-bedroom first-floor flat nestled in the picturesque town of Bexhill. This cozy residence boasts separate living rooms, offering both privacy and comfort for residents. As you step inside, you'll be greeted by distant sea views, providing a serene backdrop to everyday life. Convenient parking ensures hassle-free commuting, while the property's ideal location offers easy walking access to the vibrant Bexhill town center, where you'll find an array of amenities, shops, and dining options. Whether you're seeking a peaceful retreat or a convenient urban lifestyle, Adhesive Lodge offers the perfect blend of tranquility and accessibility.







**Lounge**  
21'10 x 13'0 (6.65m x 3.96m)

**Kitchen**  
13'9 x 8'11 (4.19m x 2.72m)

**Bedroom 1**  
13'8 x 13'5 (4.17m x 4.09m)

**Bedroom 2**  
10'4 x 9'8 (3.15m x 2.95m)

**Council Tax Band - B £1810**

**Lease Information**

The seller advises that the property is offered as leasehold and has approximately 96 years remaining on the lease. The service charge is approximately £1,600 per annum with a ground rent of £200 per annum.



## Floor Plan

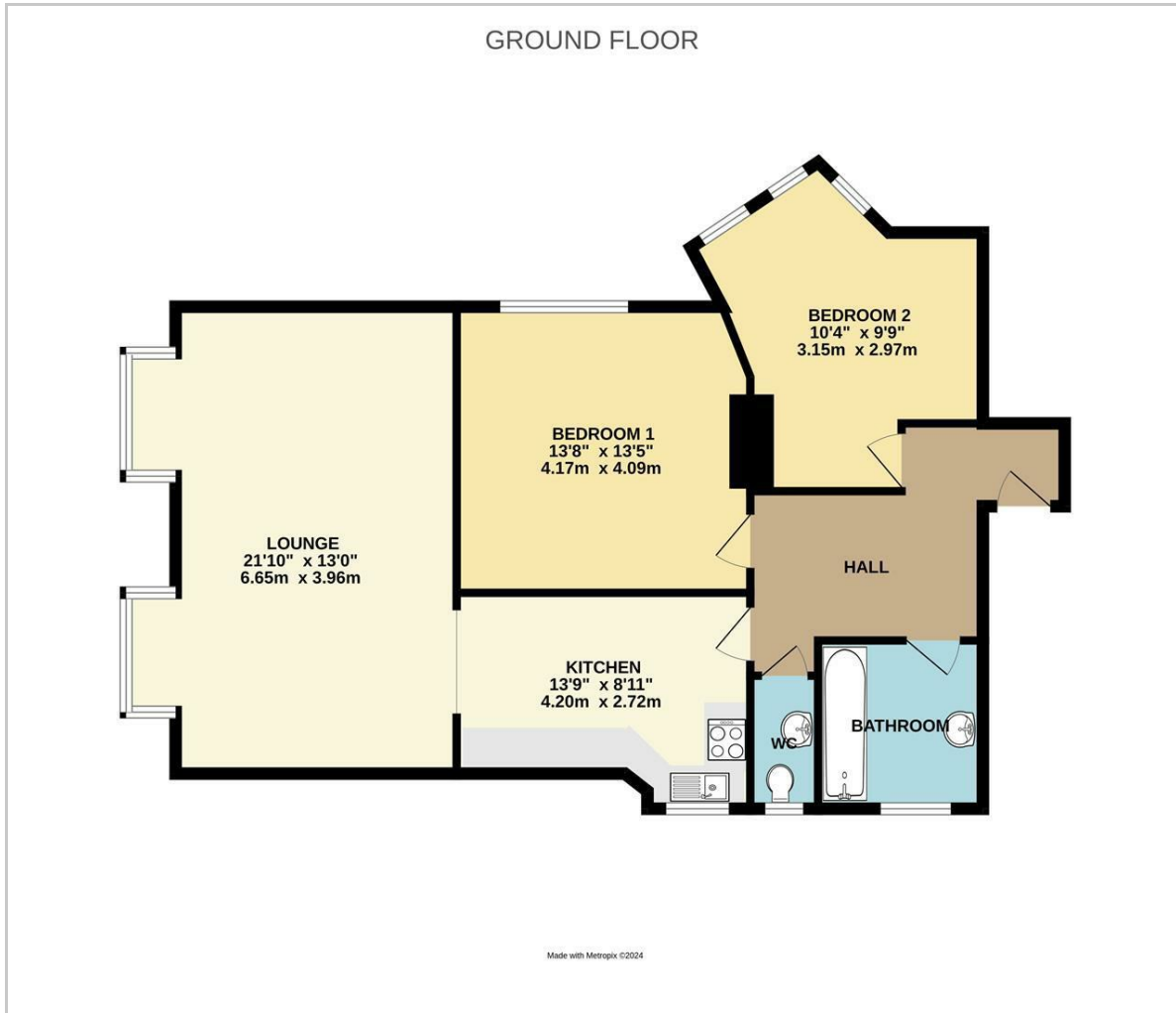

## Viewing

Please contact us on 01424 224700 if you wish to arrange a viewing appointment for this property or require further information.

These particulars, whilst believed to be accurate are set out as a general outline only for guidance and do not constitute any part of an offer or contract. Intending purchasers should not rely on them as statements of representation of fact, but must satisfy themselves by inspection or otherwise as to their accuracy. No person in this firm's employment has the authority to make or give any representation or warranty in respect of the property.

## Area Map



## Energy Efficiency Graph

