



## South Park Road, SW19

### £350,000

A top floor one double bedroom apartment located in a superb, central location. The property has a garage to the rear and is sold with no onward chain, alongside a long lease.

South Park Road is a popular tree lined road next to South Park Gardens. This area has a fantastic selection of High Street brand shops, popular restaurants and excellent transport links just a short walk away.

### Features

- Top Floor
- Garage To The Rear
- No Onward Chain
- Central Location
- Long Lease
- Over 40 Square Meters

# South Park Road, London, SW19

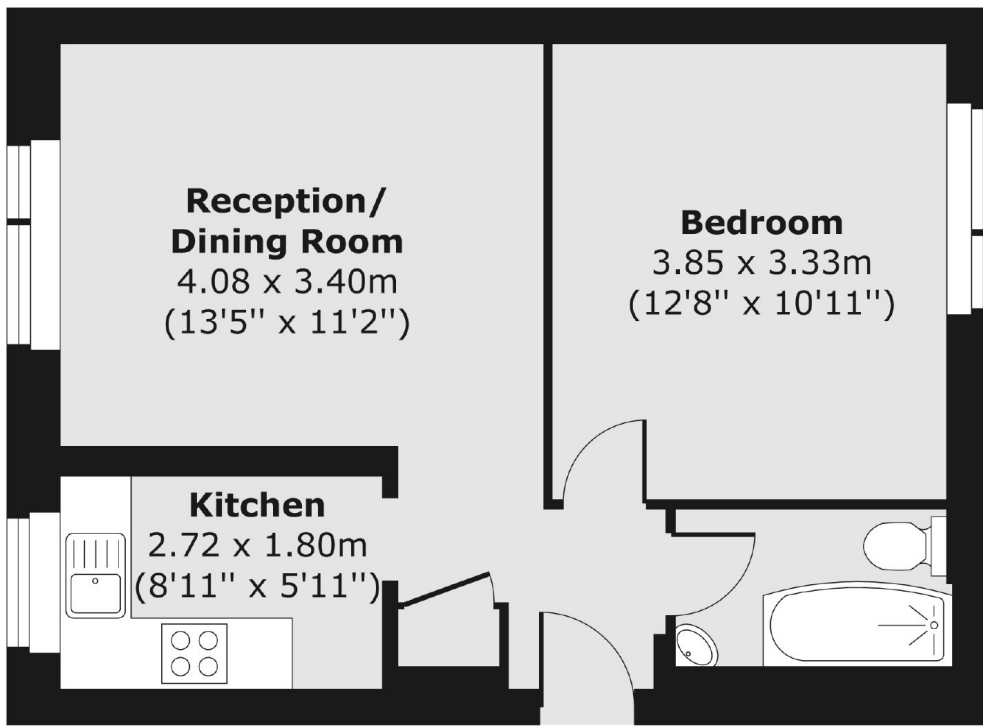

Total area (approx.) 40.33 sq. m (434 sq. ft)