



Bowman Mews, SW18

£2,500 Per calendar month

A two double bedroom house with a separate modern kitchen and large living space that leads directly to the private garden on the ground floor, upstairs there is a bathroom with shower over bath.

Bowman Mews is a cul-de-sac off Standen Road allowing easy access to Southfields village, the Marks and Spencer, Tube station and eateries and coffee shops the area has to offer.

Features

- Two Bedrooms
- Separate Kitchen
- Wooden Flooring
- House
- Garden
- Garage

Bowman Mews, London, SW18

Ground Floor

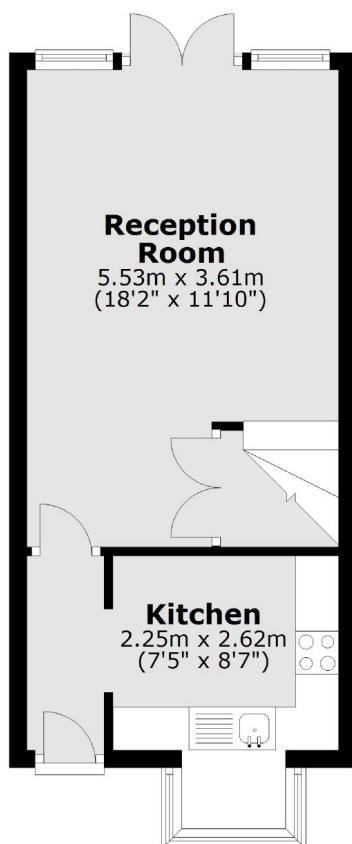

First Floor

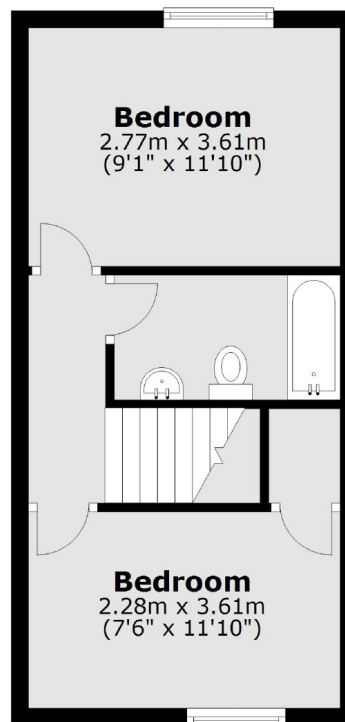

Total area: approx. 58.1 sq. metres (625.2 sq. feet)