



## Elm Grove, SW19

£1,750 Per calendar month

A one bedroom/studio property on the ground floor of a recently completed development. The unit has an open plan kitchen/living space, wooden flooring and a tiled bathroom with shower over bath.

Cree Studios are located off Elm Grove. Elm Grove is cul-de-sac just over half a mile from Wimbledon Broadway and station allowing easy access to the town centre's restaurants and shops.

### Features

Wooden Flooring  
Open Plan Kitchen  
Plenty of Storage  
Parking  
Ground Floor  
Wimbledon Station

# Elm Grove, London, SW19

## Ground Floor

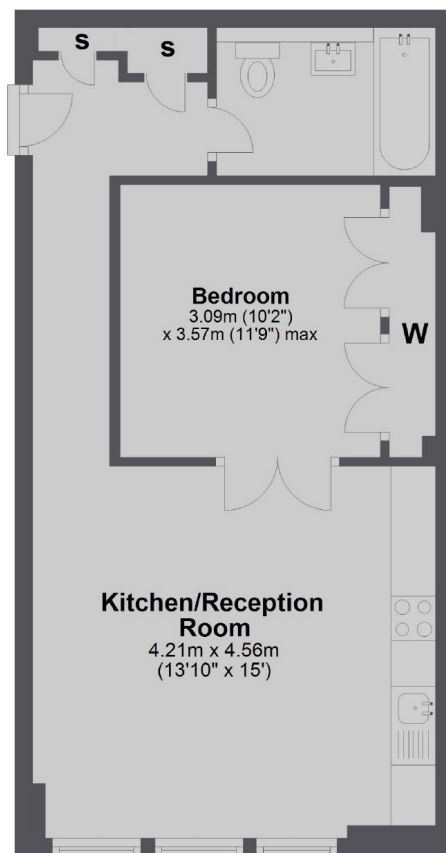

Total area: approx. 41.8 sq. metres (450.0 sq. feet)