



Haydon Park Road, SW19
£1,595,000

Dexters



Haydon Park Road, SW19

One of the most exceptional examples of an extended Victorian semi detached house, in the Wimbledon area. This four bedroom, three bathroom property is sold with a south facing, near 100 foot garden. The ground floor has been opened up in its entirety to create the most incredible kitchen/ reception/ dining room, with underfloor heating throughout and bifolding doors to the garden. The garden measures nearly a hundred feet, is south facing and encompasses a patio, lawn, vegetable patch and space for a studio.

The first floor has two double bedrooms and two bathrooms, with a bespoke window located at the back of the house, overlooking the garden, framing it perfectly. There is underfloor heating in all rooms, with all windows triple glazed.

The loft has been converted, using London stock bricks and allowing the extension to seamlessly fit with the rest of the exterior of the house. The retractable, large Velux window in the rear bedroom, facing the garden, adds to the luxury that is felt throughout the house.

The area is highly sought-after due to the good schools and close proximity to green open spaces. Haydons Road is a quiet street in a very convenient location with Thames Link being 0.1 mile away and Wimbledon Park 0.6 miles away.

Features

- Triple Glazed Windows
- End Of Terrace
- Four Bedrooms
- Three Bathrooms
- South Facing Garden
- Underfloor Heating On All







Haydon Park Road, London, SW19

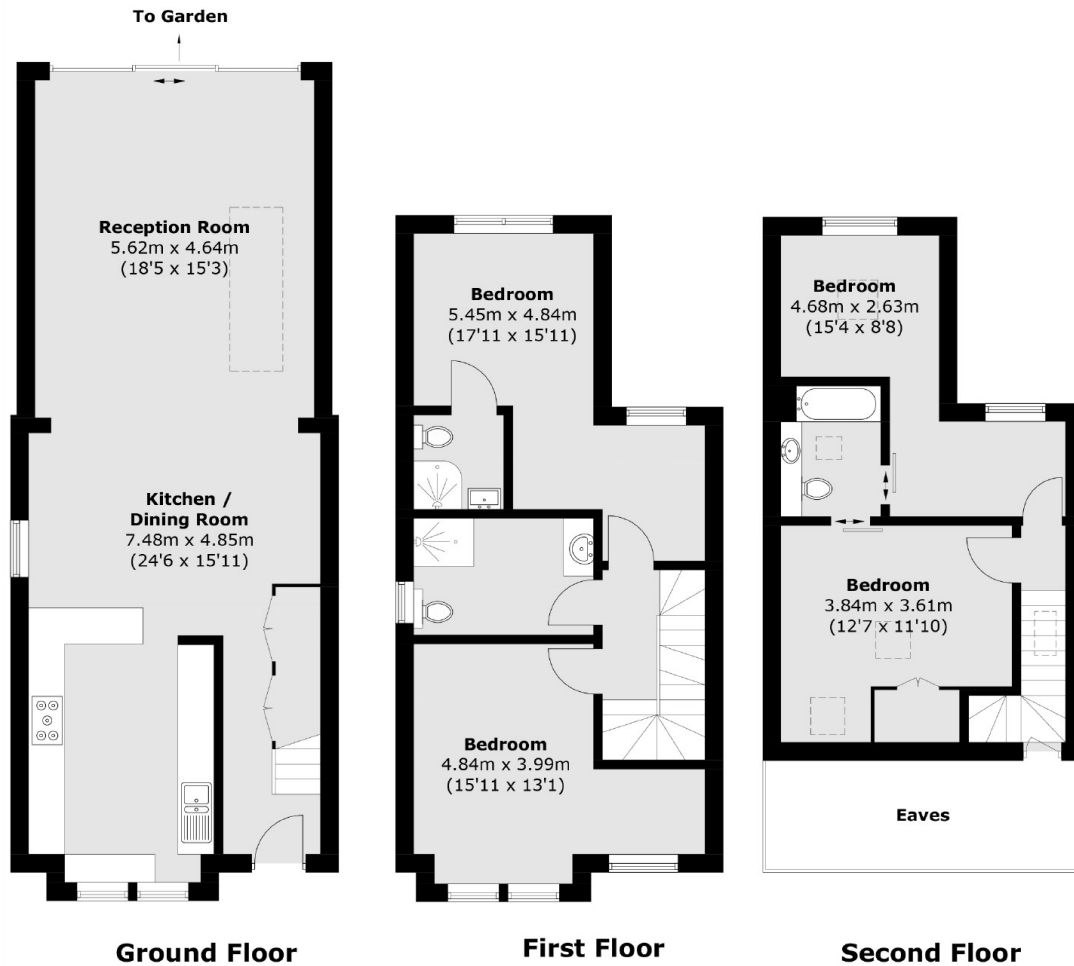

Total area (approx.): 141.7 sq. m (1,525.2 sq. ft)
(Excluding Eaves)

Dexters

Wimbledon
12 The Broadway
London
SW19 1RF
Sales
020 8545 8580

Energy Rating: C. We aim to make our particulars both accurate and reliable. However they are not guaranteed; nor do they form part of an offer or contract. If you require clarification on any points then please contact us, especially if you're traveling some distance to view. Please note that appliances and heating systems have not been tested and therefore no warranties can be given as to their good working order.

 **RICS** | Regulated
Estate Agent
and Letting Agent

[dexters.co.uk](https://www.dexters.co.uk)