



Caxton Road, SW19

£500,000

A two double bedroom ground floor Victorian conversion with a private garden. The property is in superb condition, located just a few steps away from the park and offers the potential to further extend.

Located in the much sought after Poet's area, on a family orientated street and within the catchment for two primary schools and close to the Thames Link, London is just moments away!

Features

- Two Bedrooms
- Victorian Conversion
- Beside the Park
- Private Rear Garden
- Extension Potential
- Quiet Street

Caxton Road, London, SW19

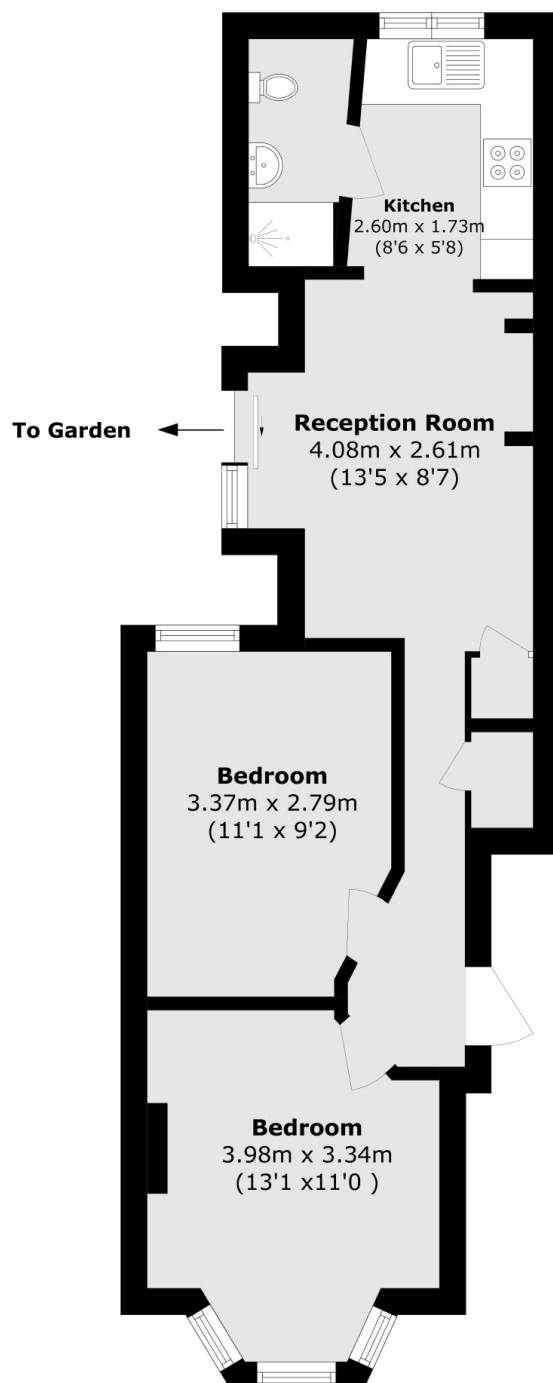

Total area (approx.): 49.7 sq. m (534.9 sq. ft)

Dexters

Wimbledon
12 The Broadway
London
SW19 1RF
Sales
020 8545 8580

Energy Rating: . We aim to make our particulars both accurate and reliable. However they are not guaranteed; nor do they form part of an offer or contract. If you require clarification on any points then please contact us, especially if you're traveling some distance to view. Please note that appliances and heating systems have not been tested and therefore no warranties can be given as to their good working order.

 **RICS** | Regulated
Estate Agent
and Letting Agent

[dexters.co.uk](https://www.dexters.co.uk)