



Kingston Road, SW19

£675,000

A two double bedroom, two bathroom ground floor Edwardian conversion. There is a large basement, garage in block, large private garden with direct access, with a share of freehold and no onward chain.

Perfectly located for Wimbledon Town Centre and Dundonald Park. Close to transport links with Wimbledon Tube, Overground Station and The Broadway offering an eclectic range of restaurants and bars.

Features

- Two Double Bedrooms
- Two Bathrooms
- Large Private Garden
- Garage In Block
- Share Of Freehold
- No Onward Chain

Kingston Road, London, SW19

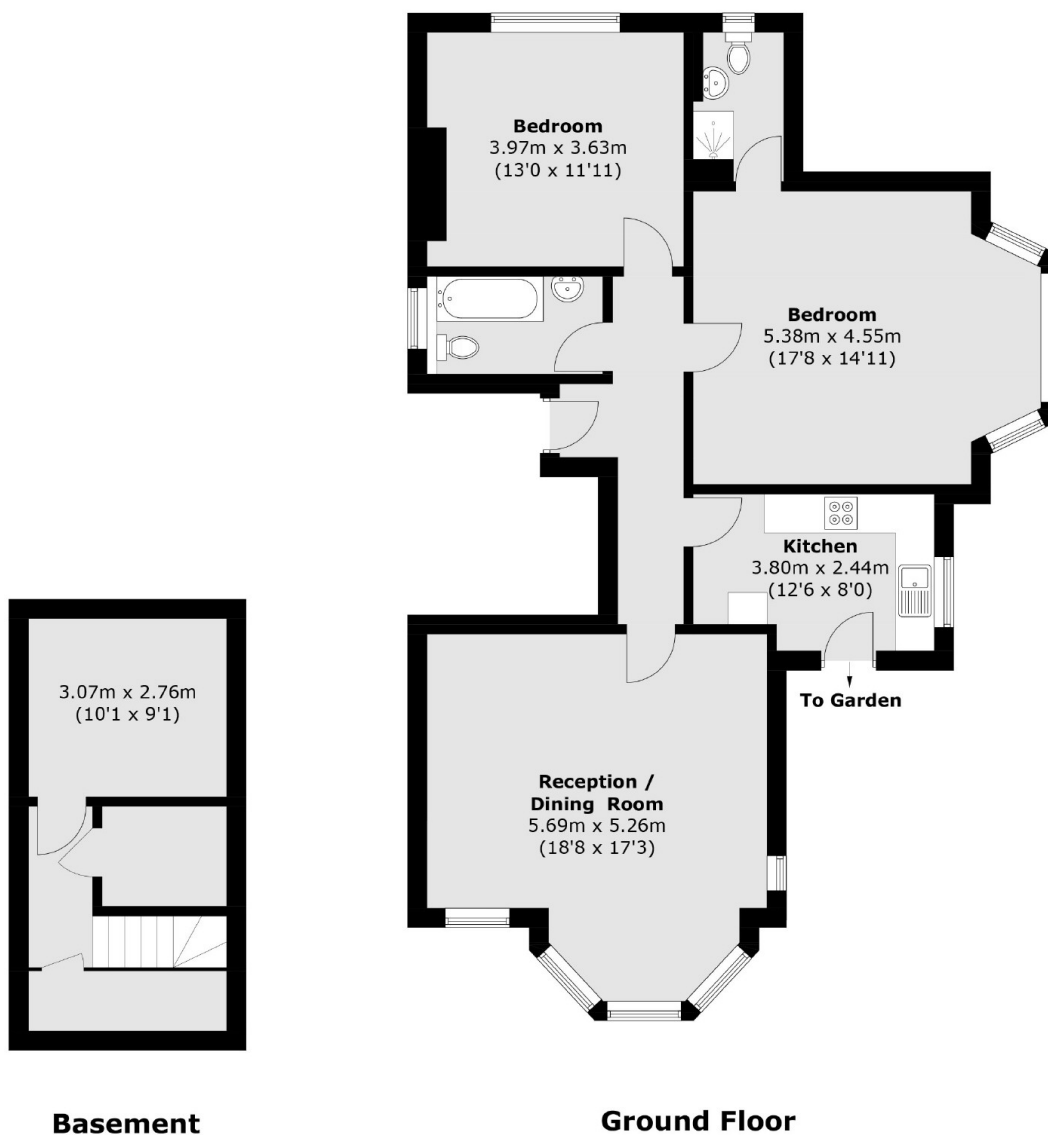

Total area (approx.): 89.1 sq. m (959.1 sq. ft)
Basement (approx.): 19.6 sq. m (210.9 sq. ft)