



Church Lane, SW19

£200,000

This is a One double bedroom modern purpose built retirement apartment for over 60's. The property is in immaculate condition throughout. The development has two communal lounge areas, laundry room, a well maintained communal garden with secure gated parking. The property offers no onward chain.

Andridge Court is located within a short distance to the Northern Line, District Line, South West Main Line, as well as the Tram Line, providing a huge array of easily accessible transport both into the heart of London as well as to the coast.

Features

- Retirement Development For Over 60's
- One Double Bedroom
- Communal Garden
- Gated Parking
- No Chain

Church Lane, London, SW19

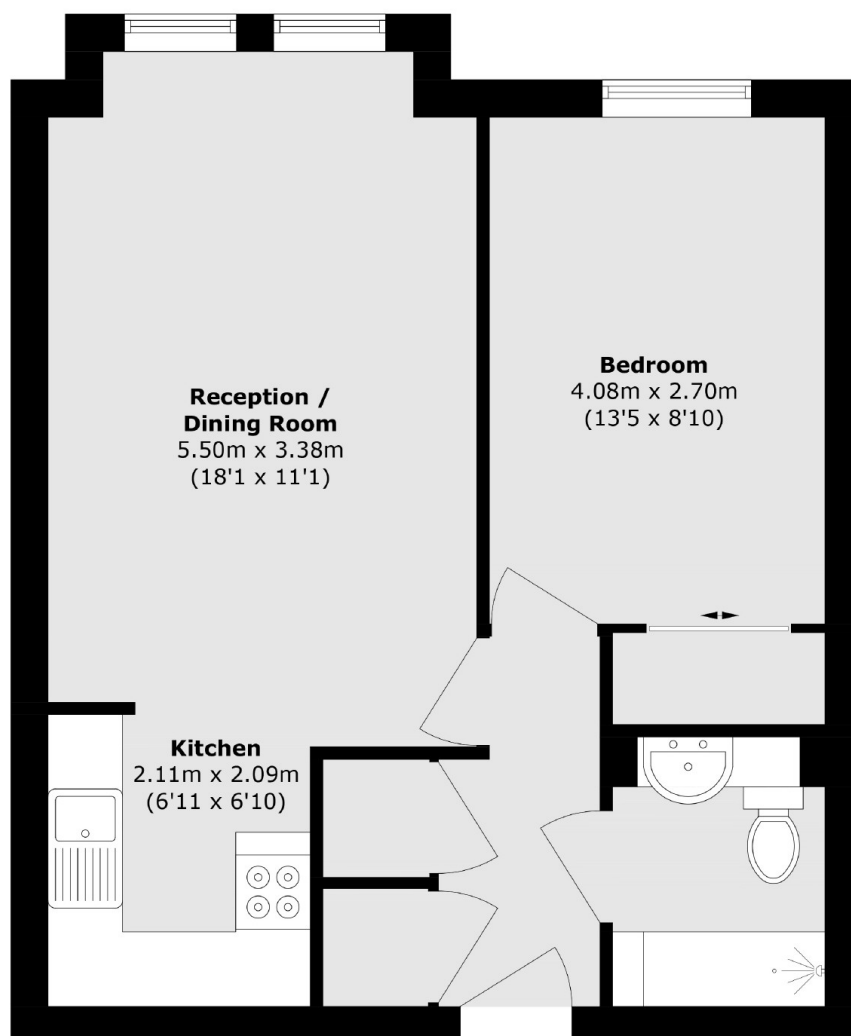

Total area (approx.): 46.0 sq. m (495.1 sq. ft)

Dexters

Wimbledon
12 The Broadway
London
SW19 1RF
Sales
020 8545 8580

Energy Rating: . We aim to make our particulars both accurate and reliable. However they are not guaranteed; nor do they form part of an offer or contract. If you require clarification on any points then please contact us, especially if you're traveling some distance to view. Please note that appliances and heating systems have not been tested and therefore no warranties can be given as to their good working order.

 **RICS** | Regulated
Estate Agent
and Letting Agent

[dexters.co.uk](https://www.dexters.co.uk)