



Southdown Road, SW20

£550,000

One of the finest examples of a two double bedroom, ground floor maisonette. The property has a beautiful private rear garden and is sold with a share of freehold.

Located between Wimbledon and Raynes Park. There is excellent transport links as well as local shops and great restaurants. If you fancy a stroll up to Wimbledon Common/Village there are some cracking bars to enjoy as well.

Features

- Two Bedrooms
- Two Bathrooms
- Ground Floor
- Private Garden
- Share of Freehold
- Excellent Condition

Southdown Road, London, SW20

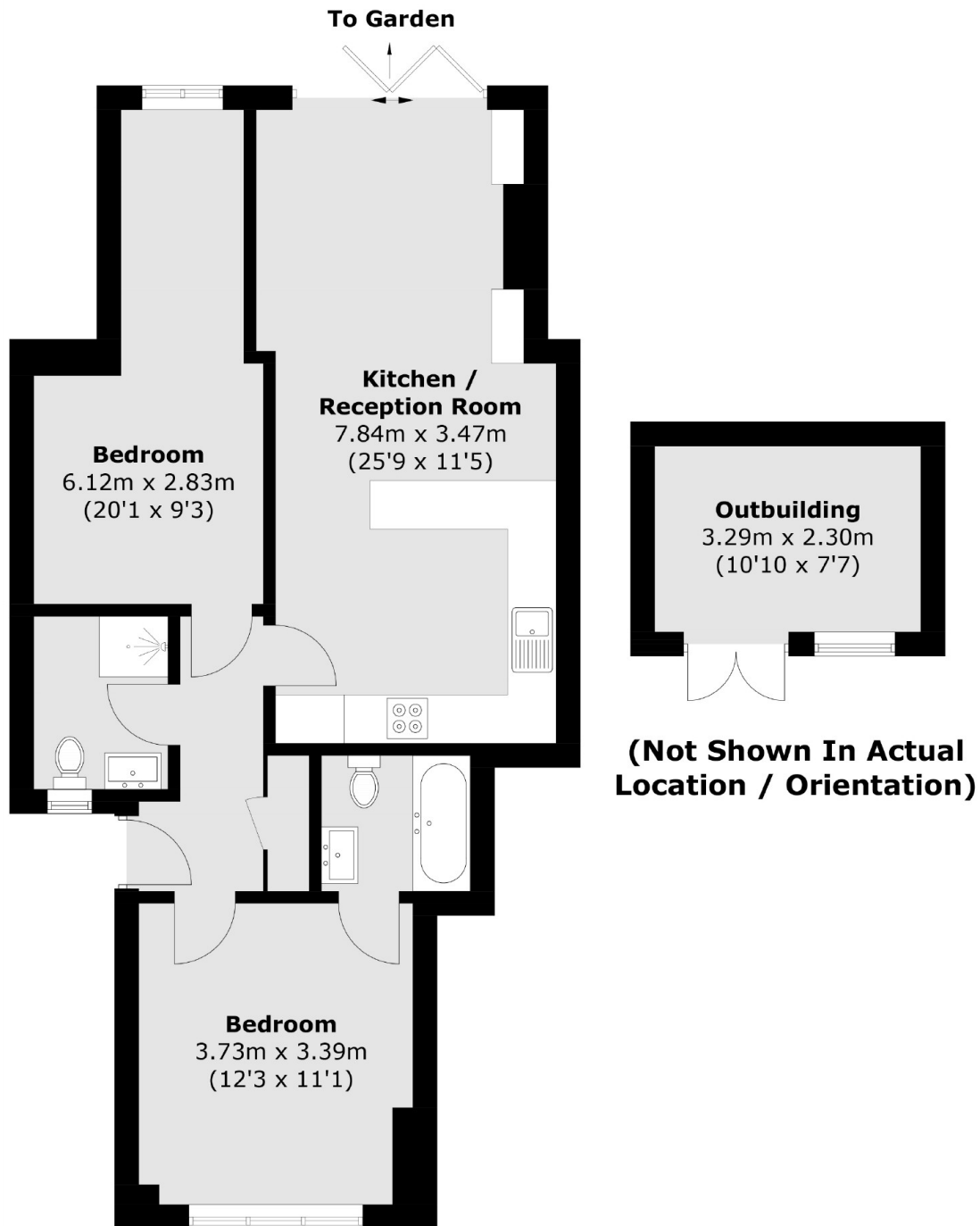

Total area (approx.): 67.9 sq. m (730.9 sq. ft)
Outbuilding: 7.8 sq. m (83.9 sq. ft)
Total: 75.7 sq. m (814.8 sq. ft)