

Vineyard Hill Road, SW19

£285,000

A beautifully presented, ground floor studio flat located within a large Victorian house. There are lovely communal gardens, a separate kitchen, wonderful high ceilings and original windows.

Located on one of Wimbledon's most desirable roads, with Wimbledon Park Station only around the corner, along with numerous shops and restaurants. Everything you need is only a short walk away, including the entrance to Wimbledon Park.

Features

- Studio Flat
- Period Conversion
- No Chain
- Communal Gardens
- Excellent Location
- Great Transport Links

Vineyard Hill Road, London, SW19

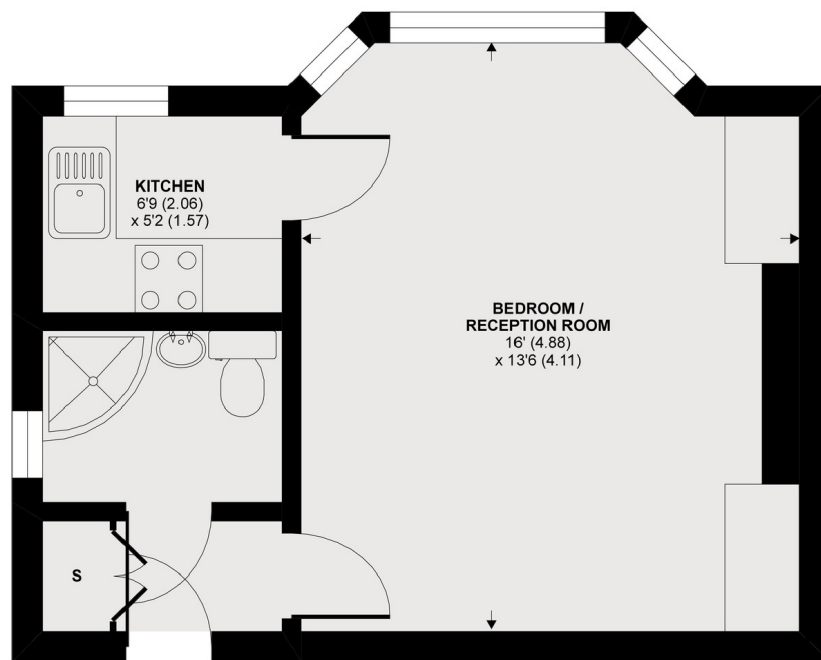

Ground Floor

APPROX FLOOR AREA 304 SQ.FT 28.2 SQ.M

Copyright nichecom.co.uk 2020 REF : 582528

Dexters

Wimbledon
12 The Broadway
London
SW19 1RF
Sales
020 8545 8580

Energy Rating: D. We aim to make our particulars both accurate and reliable. However they are not guaranteed; nor do they form part of an offer or contract. If you require clarification on any points then please contact us, especially if you're traveling some distance to view. Please note that appliances and heating systems have not been tested and therefore no warranties can be given as to their good working order.

 **RICS** | Regulated
Estate Agent
and Letting Agent

dexters.co.uk