

## Ashridge Way, SM4

### £675,000

A well presented mid terrace three bedroom 1930s house. The house has an abundance of period features and a recently renovated bathroom. The garden is south west facing, with playing field views and further benefits garden studio with a bathroom and rear access.

Ashridge Way is a fantastic residential street located close to a number of local stations with quick access into London. As well as green open spaces including Cannon Hill Common which is very nearby.

### Features

- Three Bedrooms
- Potential To Rear And Loft
- Full Garden Annexe
- Playing Field Views
- Landscaped Front & Back Gardens
- Grass Verge Frontage

# Ashridge Way, Morden, SM4

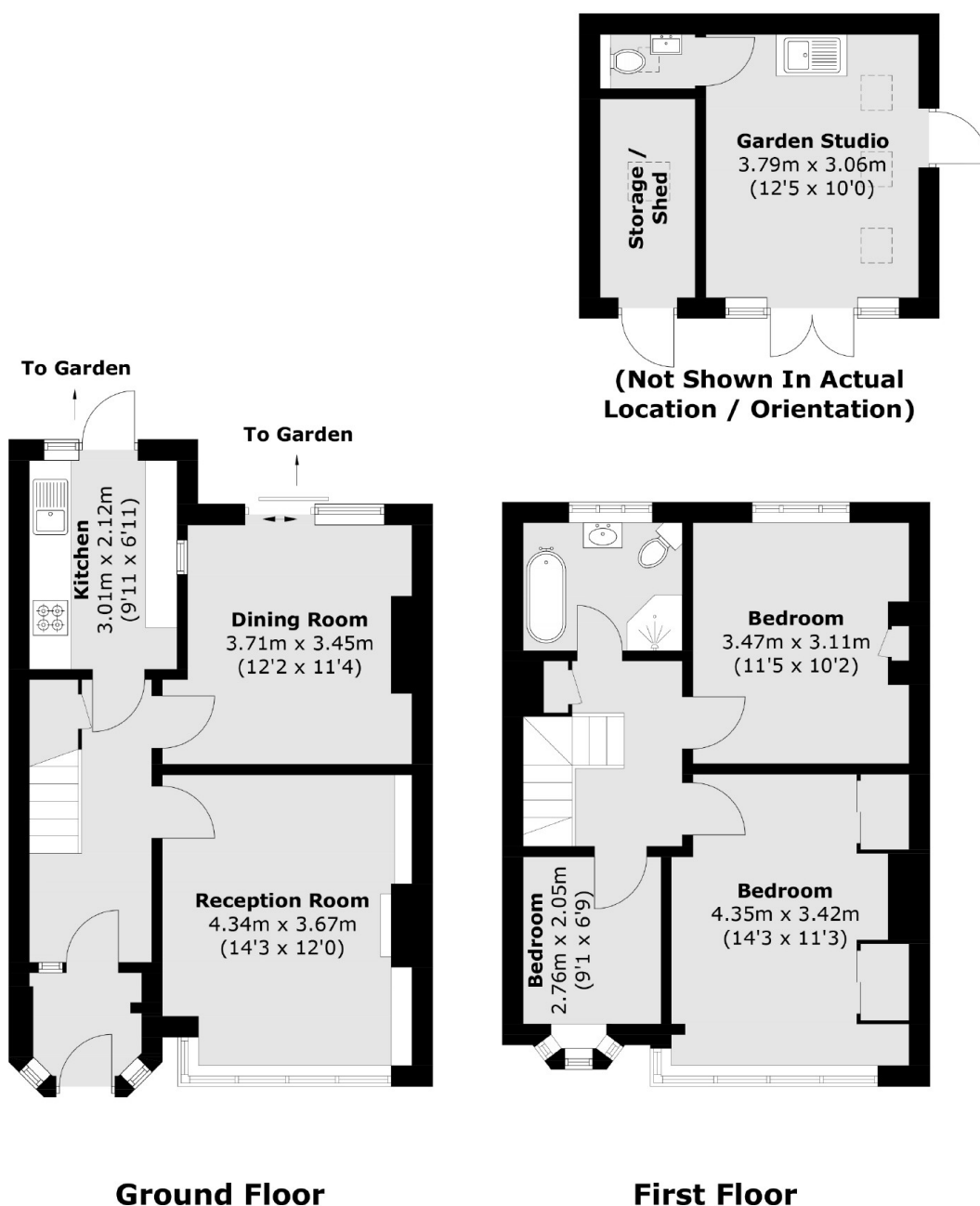

Total area (approx.): 86.8 sq. m (934.3 sq. ft)  
Outbuilding: 17.1 sq. m (184.1 sq. ft)