



Edna Road, SW20

£1,750 Per calendar month

A wonderfully designed and built one-bedroom apartment on the third floor with two private outdoor spaces and open plan living with an integrated kitchen

The Zero is located in Raynes Park and is opposite David Lloyd and playing fields. It also has great access to mainline stations at Raynes Park and Wimbledon Chase and a short bus ride to the Northern Line, South Wimbledon. Whilst Raynes Park has a great selection of pubs, restaurants and amenities the buzzer towns of Wimbledon and Kingston are just around the corner.

Features

- One Double Bedroom
- Large Balcony
- Sustainability Award
- Stunning Specification
- Great Transport
- Low Running Costs

Edna Road, London, SW20

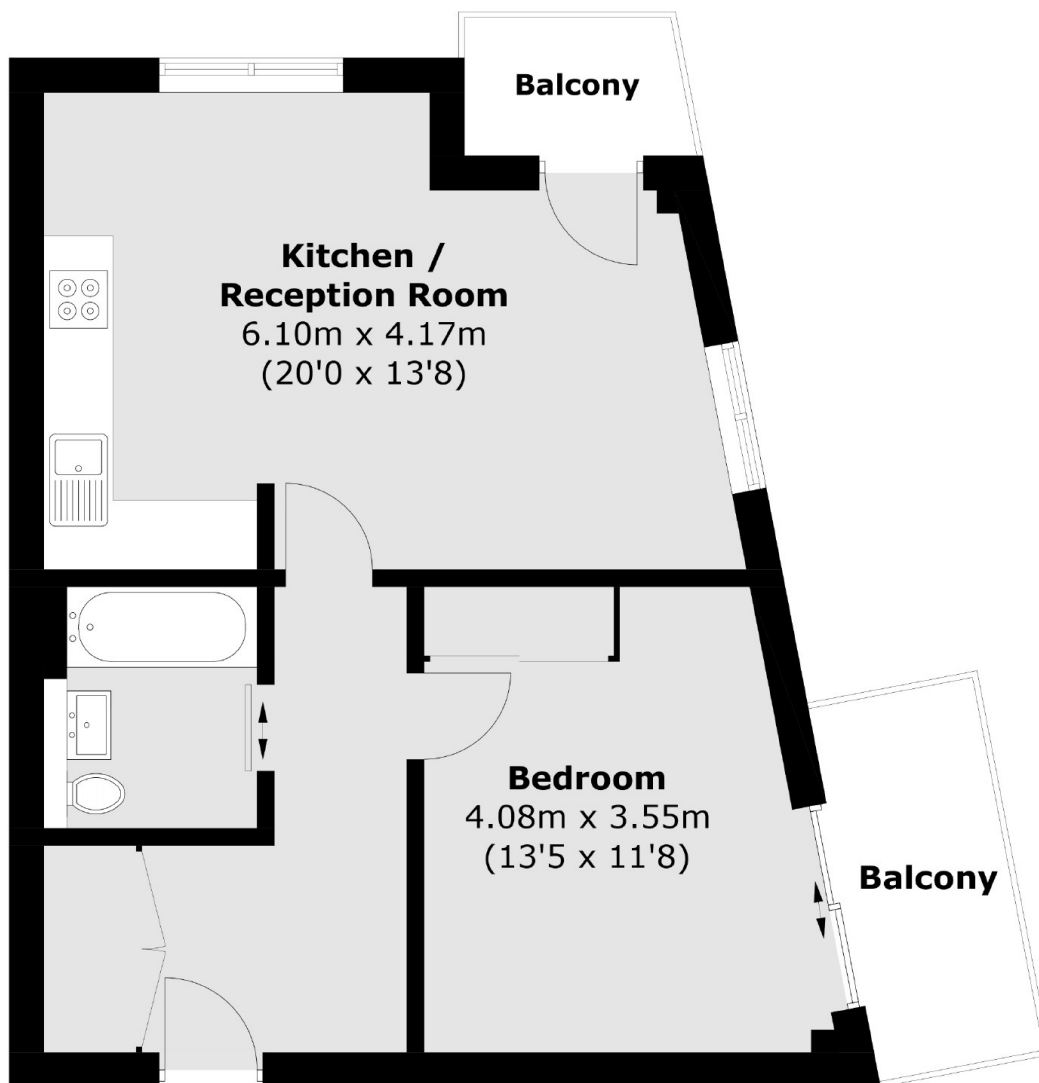

Total area (approx.): 49.8 sq. m (536 sq. ft)
Balcony area (approx.): 7.1 sq. m (76.4 sq. ft)