



## Wimbledon Park Road, SW19

£3,250 Per calendar month

This lateral four double bedroom, top floor apartment, offers a separate spacious living room, small private balcony, as well as a separate kitchen, and bathroom with shower over bath.

Verebank is setback from Wimbledon Park Road and allows easy access to the green open space of Wimbledon Park, as well as the array of shops, bars and restaurants in Southfields and the Underground.

### Features

- Four Bedrooms
- One Bathroom
- Private Balcony
- Wandsworth Council
- Close To Station
- Amazing View of London

# Wimbledon Park Road, London, SW19

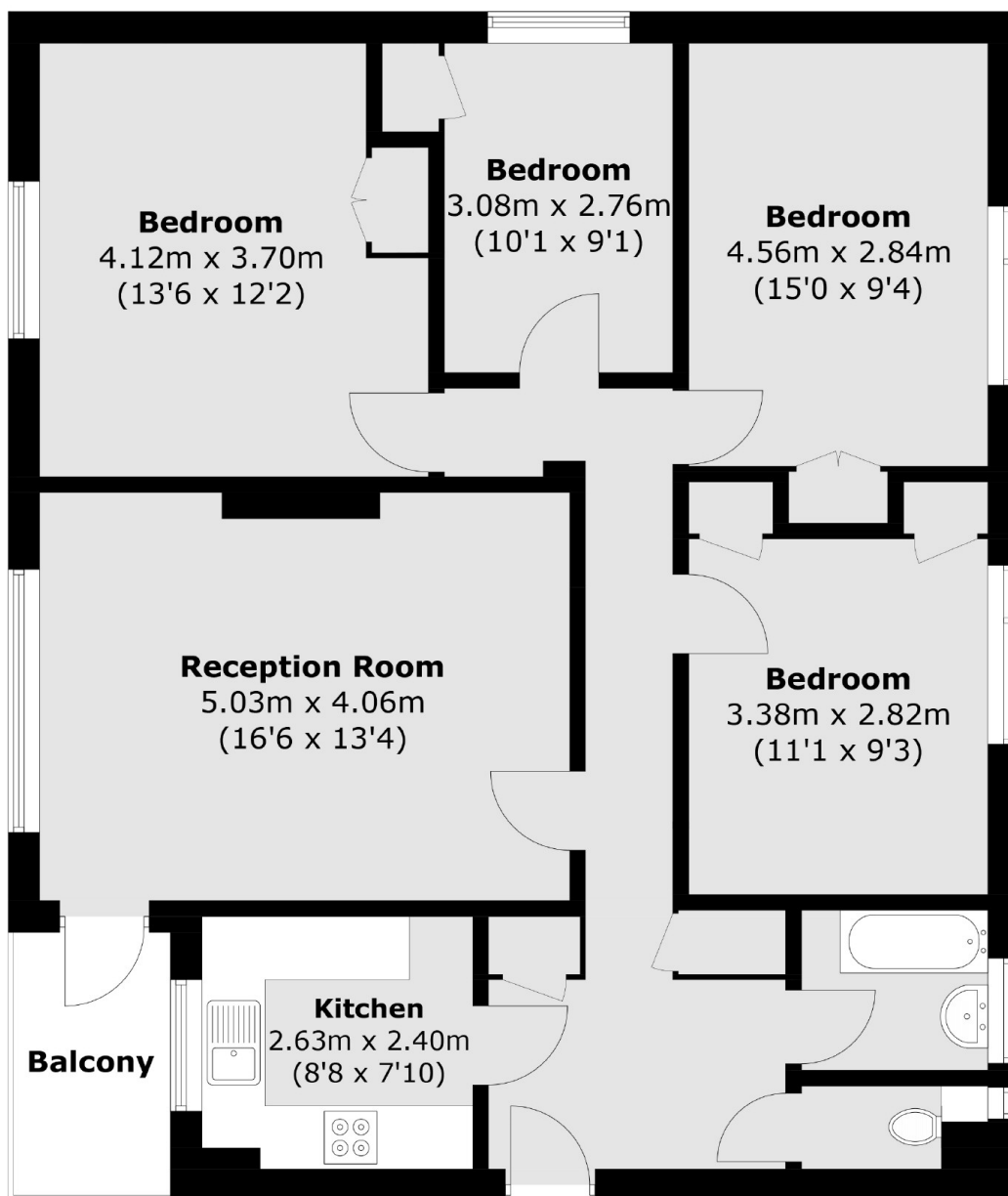

Total area (approx.): 92.6 sq. m (996.7 sq. ft)  
Balcony: 3.7 sq. m (39.8 sq. ft)