



Worple Road, SW20

£519,500

A two bedroom, ground floor garden flat, with a private area of garden, opening on to an expansive communal garden. The ceilings are high, the condition is superb and there is no onward chain.

Located just a short distance from central Wimbledon with the district line tube, overground train and tram line, as well as exclusive shops, restaurants, pubs and bars.

Features

- Own Front Door
- Two Bedrooms
- Private and Communal Gardens
- High Ceilings
- Separate Kitchen
- Victorian Conversion

Worple Road, London, SW20

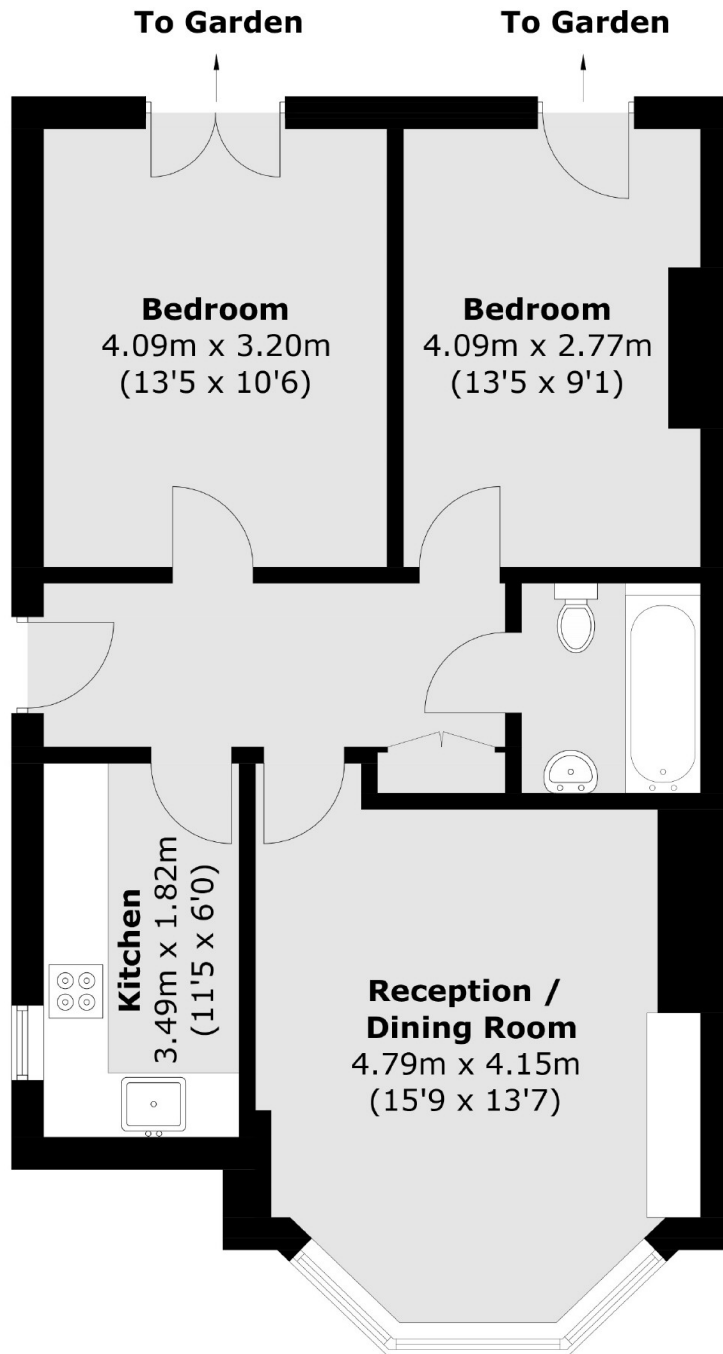

Total area (approx.): 63.6 sq. m (684.6 sq. ft)