



Vale Crescent, SW15

£395,000

A two bedroom, first floor purpose built maisonette, complete with a large private garden. The property has a long lease, a garage and the ability to park both on and off street.

Located between Wimbledon Common and Richmond Park, perfect for those Sunday walks. The A3 is just moments away and there are regular bus links.

Features

- Two Bedrooms
- Garage
- Off Street Parking
- Large Private Garden
- Beside Wimbledon Common
- Close To Richmond Park

Vale Crescent, London, SW15

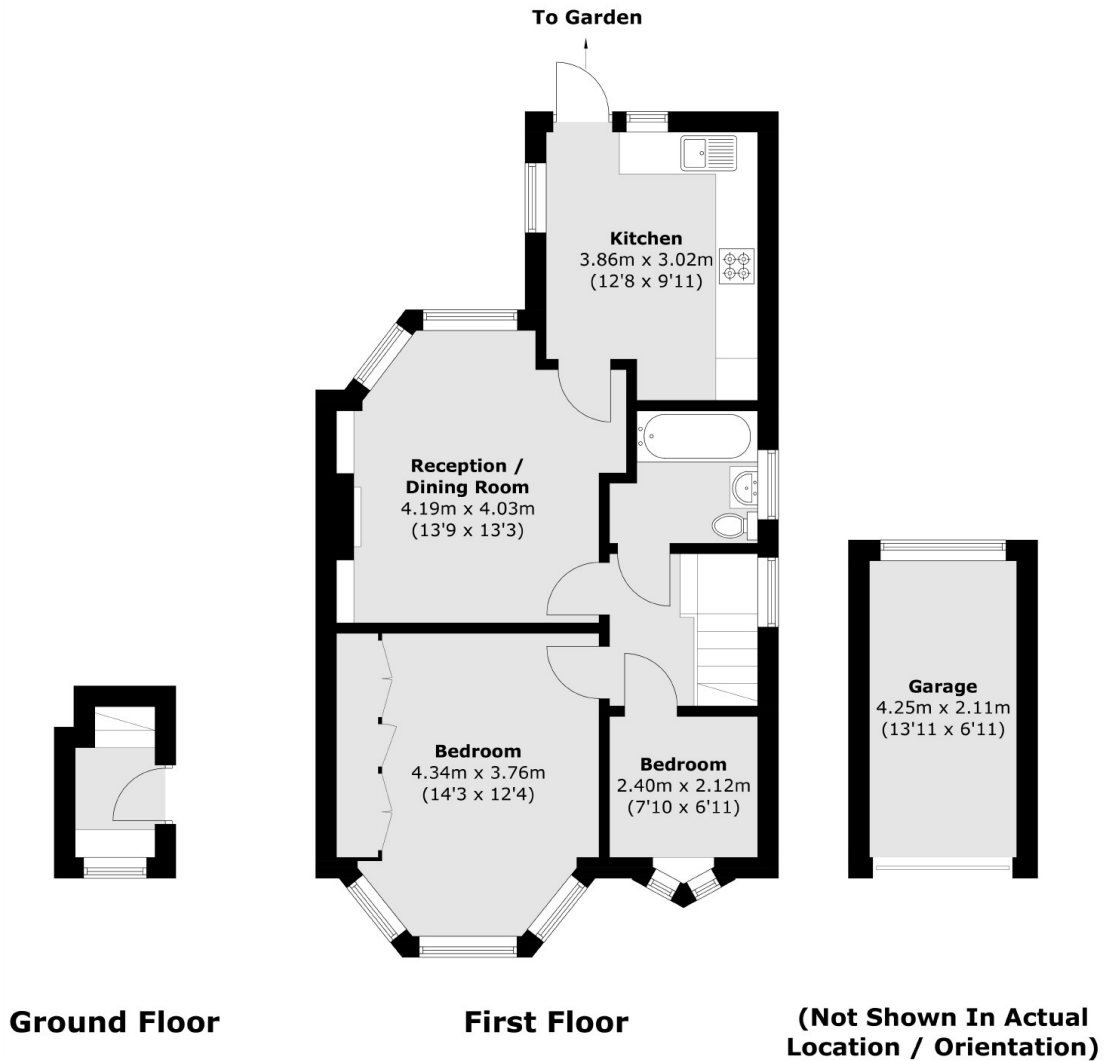

Total area (approx.): 58.6 sq. m (630.7 sq. ft)
Garage: 8.9 sq. m (95.8 sq. ft)