



Faraday Road, SW19

£3,450 Per calendar month

SHORT LET - A two bedroom end of terrace house with a large reception room with wooden floors leading to a separate contemporary kitchen with a breakfast bar and doors on to the rear garden.

The property is in a residential part of Wimbledon that is walking distance to South Park Gardens and allows easy access to Wimbledon Broadway and the station.

Features

- Two Double Bedrooms
- End of Terrace House
- Wooden Floors in Part
- Private Garden
- Contemporary Kitchen
- Modern Bathroom

Faraday Road, London, SW19

Ground Floor

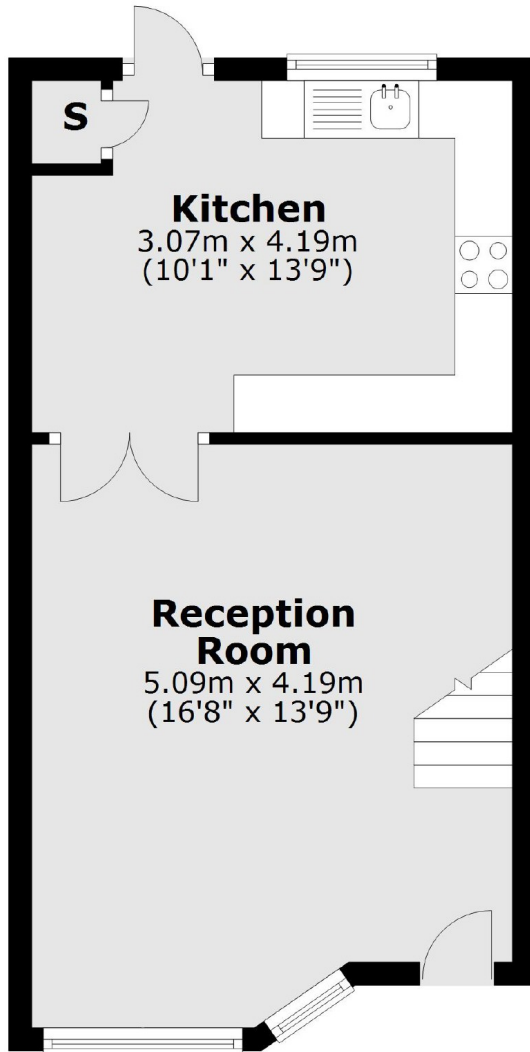

First Floor

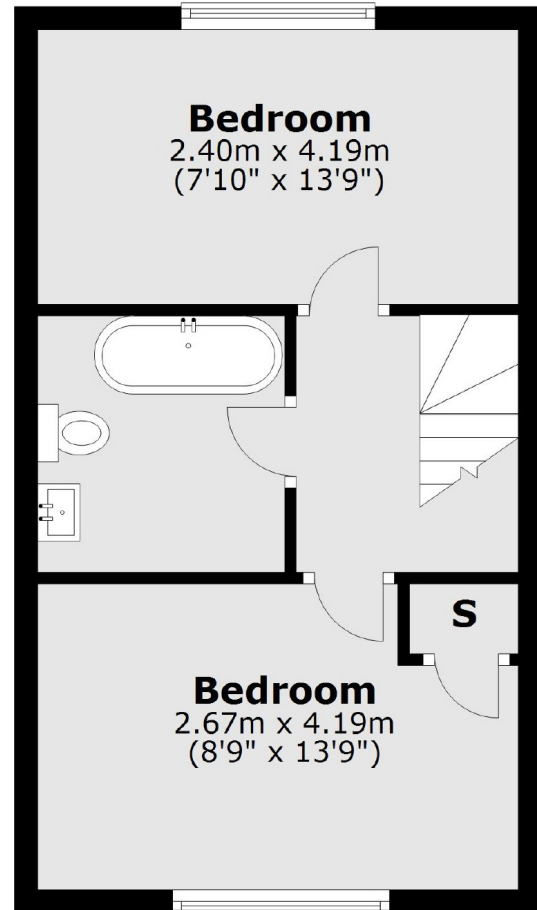

Total area: approx. 65.0 sq. metres (699.6 sq. feet)