



## Vale Crescent, SW15

£375,000

A two bedroom, first floor maisonette with a spacious accommodation throughout and off street parking. There's a fully landscaped garden and an extended lease.

Located between Wimbledon Common and Richmond Park, perfect for those Sunday walks. The A3 is just moments away and there are regular bus links.

### Features

- Two Bedrooms
- Extended Lease
- Off Street Parking
- Quiet Location
- Close to The Common
- Maisonette

Vale Crescent,  
London, SW15

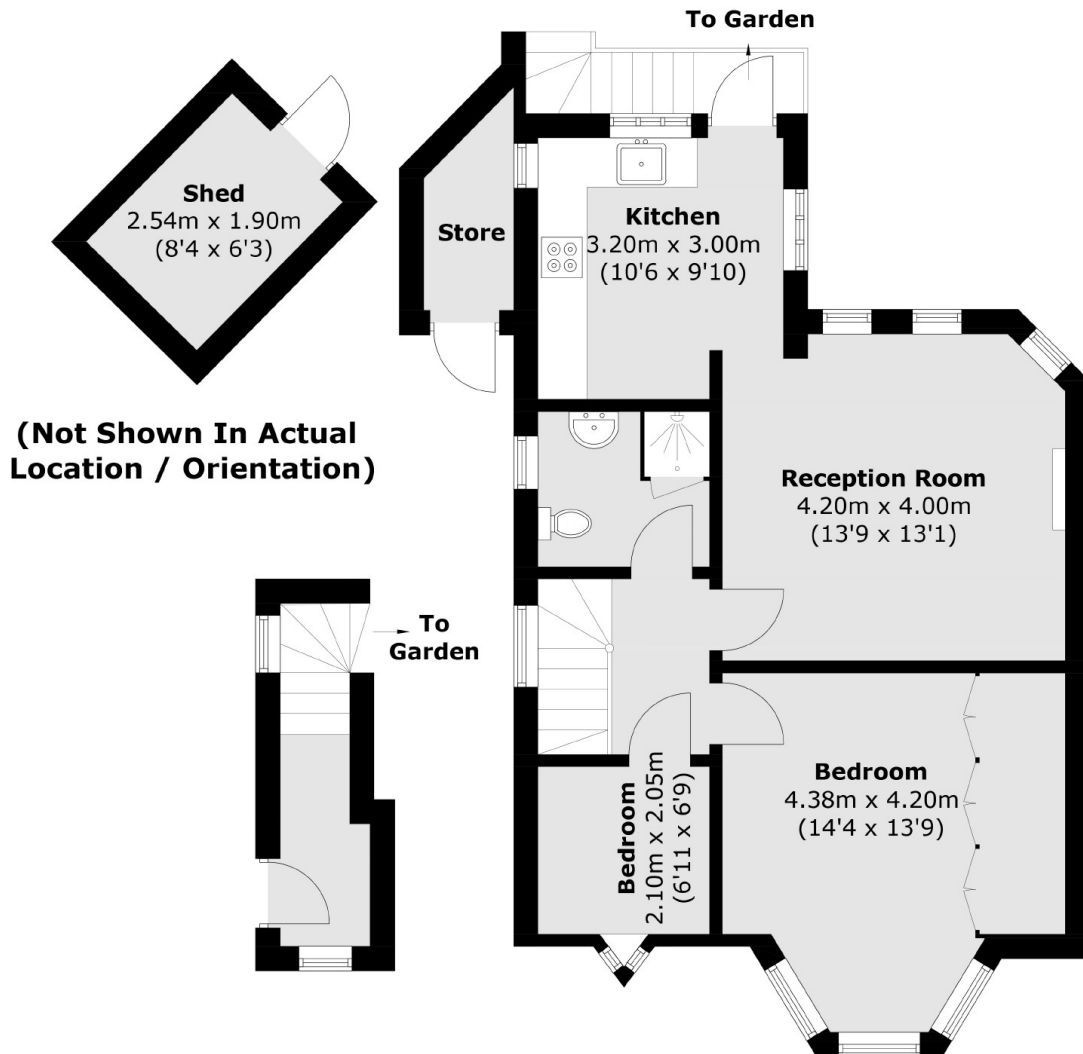

Total area (approx.): 61.0 sq. m (656.6 sq. ft)  
Shed / Store (approx.): 7.5 sq. m (80.7 sq. ft)