

## Queens Road, SW19

£395,000

A fully renovated, two bedroom first floor Victorian conversion. The apartment is complete with its own private outside space, by way of a terrace accessed via the master bedroom, a parking space and is sold with no onward chain.

Located on the edge of South Park Gardens, with nearby transport links to London from the District Line in Wimbledon town centre and Northern Line just a little further away. Vibrant bars and restaurants, are just down the road.

### Features

- Two Bedrooms
- Private Terrace
- Victorian Conversion
- Fully Renovated
- First Floor
- No Onward Chain

# Queens Road, London, SW19

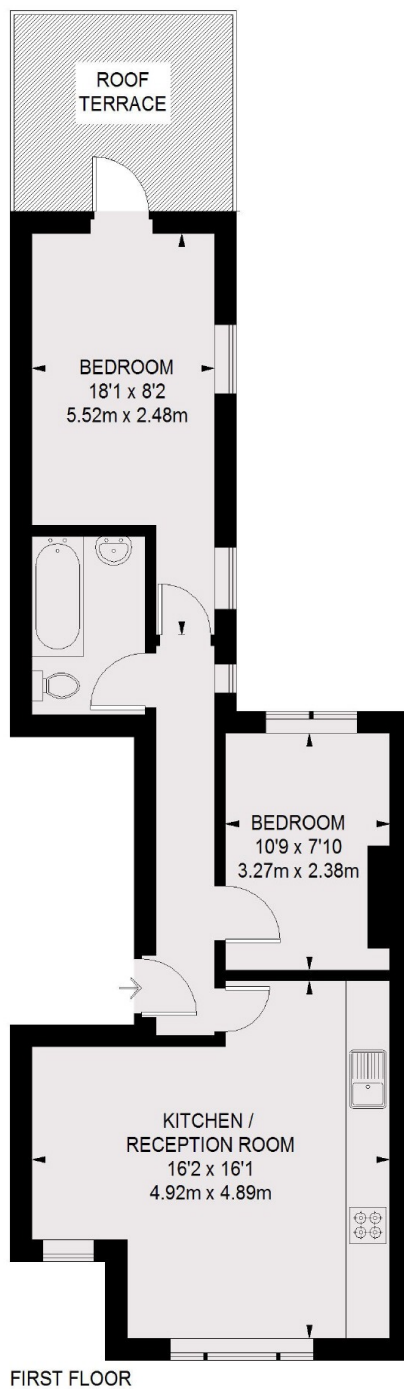

TOTAL APPROX. FLOOR AREA  
524 SQ. FT. (48.65 SQ. M.)