



Quicks Road, SW19

£695,000

A three double bedroom, two bathroom, split level Victorian maisonette. The property has a private garden, with direct access, alongside a long lease and direct views over the park.

Quicks Road is beside the sought after Battles' area within Wimbledon. Near the northern line, superb schools, a selection of shops, bars, restaurants, a cinema and a theatre, the area is vibrant and very popular.

Features

- Three Double Bedrooms
- Two Bathrooms
- South Facing Garden
- Uninterrupted Park Views
- Split Level
- Own Front Door



Quicks Road, SW19

The first floor is organised with an open kitchen/ dining room, perfect for a family, dinner parties, complete with direct access down to a perfect due south garden. The garden has been landscaped with artificial turf and paving, creating a beautiful space to enjoy in the sun.

The reception room to the front of the maisonette is a great size, with plantation shutters and uninterrupted views of the park. In addition, there is a large double bedroom and a family bathroom.

The loft has been converted to the full capacity to offer a further two bedrooms, with the master bedroom offering built in wardrobes, Juliette balcony and a separate shower room.



Quicks Road, London, SW19

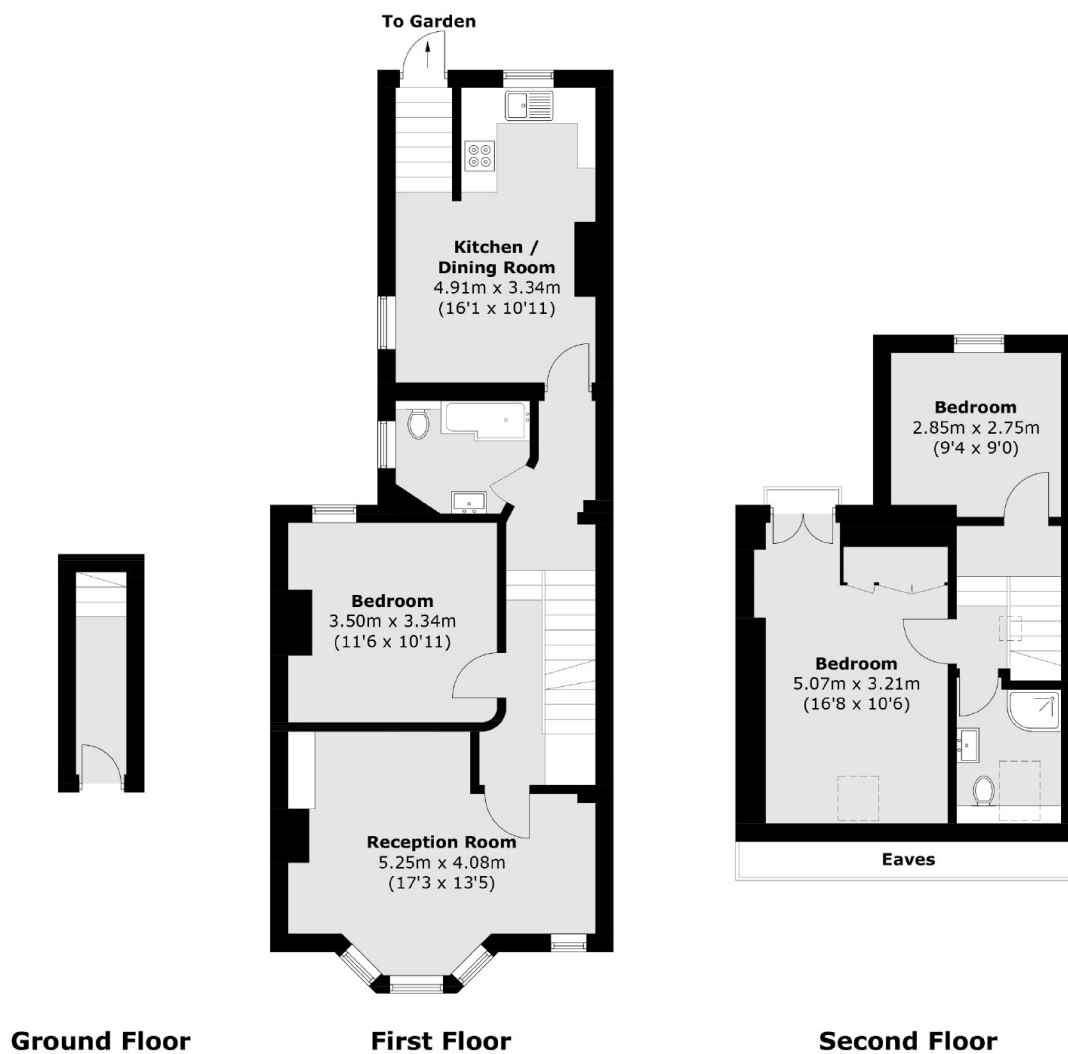

Total area (approx.): 97.9 sq. m (1,053.8 sq. ft)
(Excluding Eaves)