



Grasmere Avenue, SW19

£825,000

A five bedroom, two bathroom 1930's family home with parking for two cars. The house is ready to update and extend to create the dream family home with a west facing garden stretching in excess of a hundred feet.

Grasmere Avenue is a quiet, leafy location benefiting from excellent nearby transport links. The property lies within the catchment area for Merton Park and Poplar Primary School, and close to Old Ruts Rugby Club.

Features

- Five Bedrooms
- Two Bathrooms
- Potential To Rear Extend
- Garden Over 100 Feet
- Off-Street Parking
- No Onward Chain

Grasmere Avenue, London, SW19

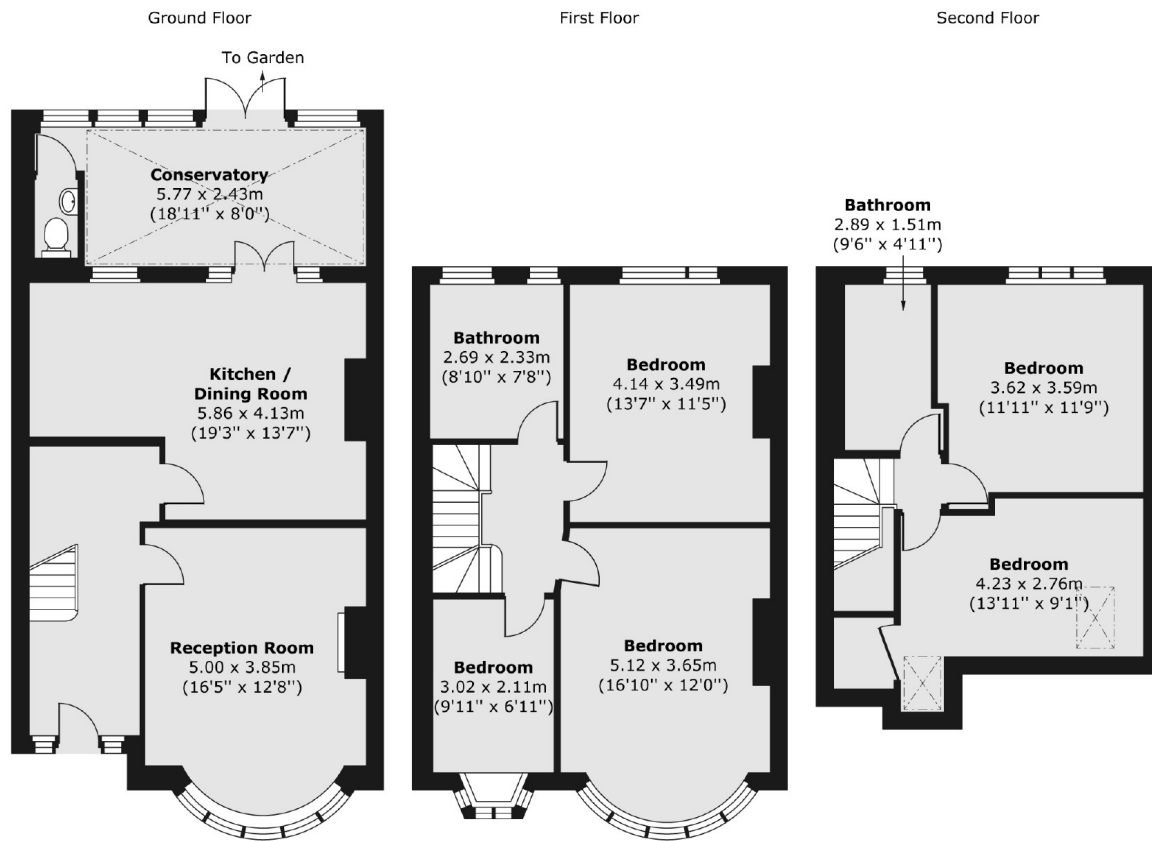

Total area (approx.) 153.01 sq. m (1,647 sq. ft)