



## Solon Road, SW2

£3,750 Per calendar month

A generous four bedroom end of terrace house set between Clapham North and Brixton. This home offers four good sized double bedrooms, a double reception room with wooden flooring, a separate kitchen with space for dining and a family bathroom.

A residential road located just off Acre Lane and within walking distance to both Clapham North and Brixton underground stations, with links into the city.

### Features

- Four Double Bedrooms
- Double Reception Room
- Wooden Flooring
- Separate Kitchen
- Bathroom And WC
- Private Garden



## Solon Road, SW2

The property has been neutrally decorated throughout and further benefits from a large private patio garden, additional WC and separate utility room.

An ideal home for professional sharers looking for spacious accommodation in an ideal location.





# Solon Road, London, SW2

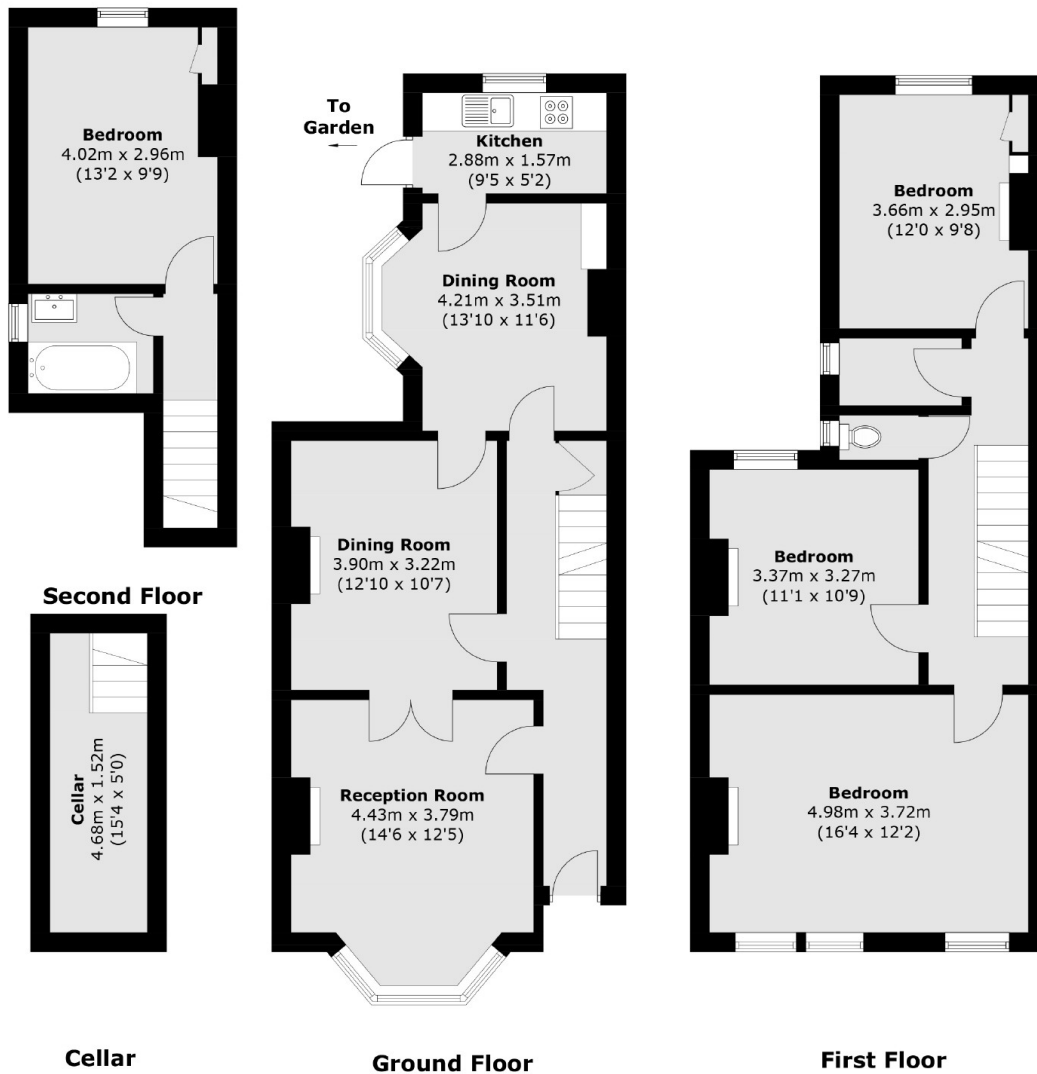

Total area (approx.): 134.6 sq. m (1,448.8 sq. ft)