



## Paradise Road, SW4

£2,500 Per calendar month

SHORT LET - This two double bedroom flat comes with a spacious reception room, separate fitted kitchen, two double bedrooms, a bathroom, neutral interior, wooden flooring throughout and a private balcony.

Offering fantastic links to the City from Stockwell underground station and with local shops and restaurants nearby, Holmes Court is perfect for young professionals.

### Features

SHORT LET  
Two Double Bedrooms  
Private Balcony  
Large Reception Room  
Separate Kitchen  
Wooden Flooring  
Close To Amenities

Paradise Road,  
London, SW4

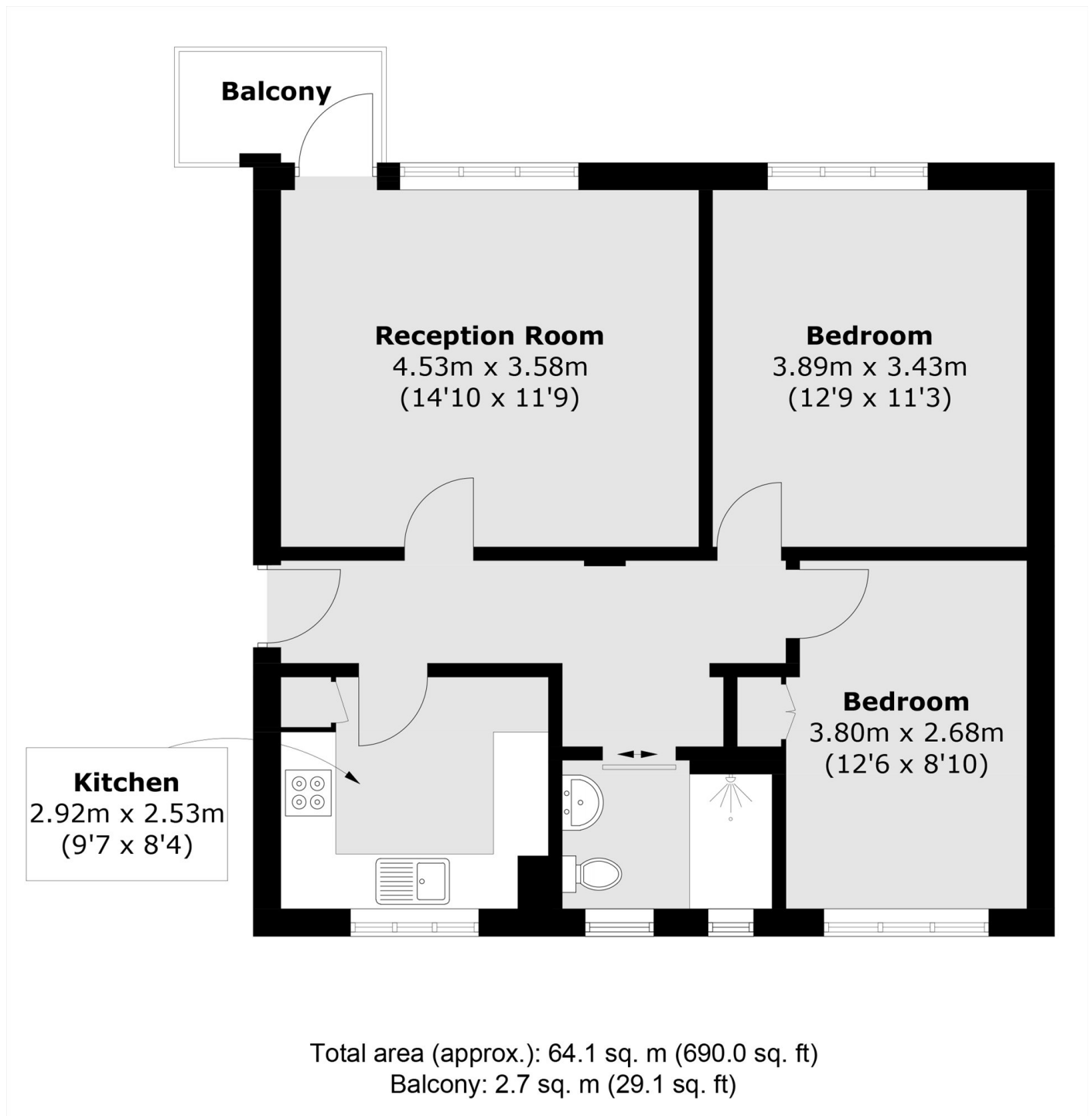

**Dexters**

Clapham High Street  
55 Clapham High Street  
London  
SW4 7TG  
Lettings  
020 7483 6364

Energy Rating: . We aim to make our particulars both accurate and reliable. However they are not guaranteed; nor do they form part of an offer or contract. If you require clarification on any points then please contact us, especially if you're traveling some distance to view. Please note that appliances and heating systems have not been tested and therefore no warranties can be given as to their good working order.

 **RICS** | Regulated  
Estate Agent  
and Letting Agent

[dexters.co.uk](https://www.dexters.co.uk)