



Concanon Road, SW2

£2,800 Per calendar month

An attractively presented two bedroom home located in the heart of Brixton, offering generous living space throughout. The property has been recently refurbished to a high standard and features a large office/study room and a private patio garden. Ideal for professional sharers.

Nestled between Clapham High Street and Brixton Town Centre, Concanon Road provides access to two of South London's most popular destinations.

Features

- Two Double Bedrooms
- Office/Study Room
- Reception Room
- Eat-In Kitchen
- Recently Refurbished
- Private Patio Garden

Concanon Road, London, SW2

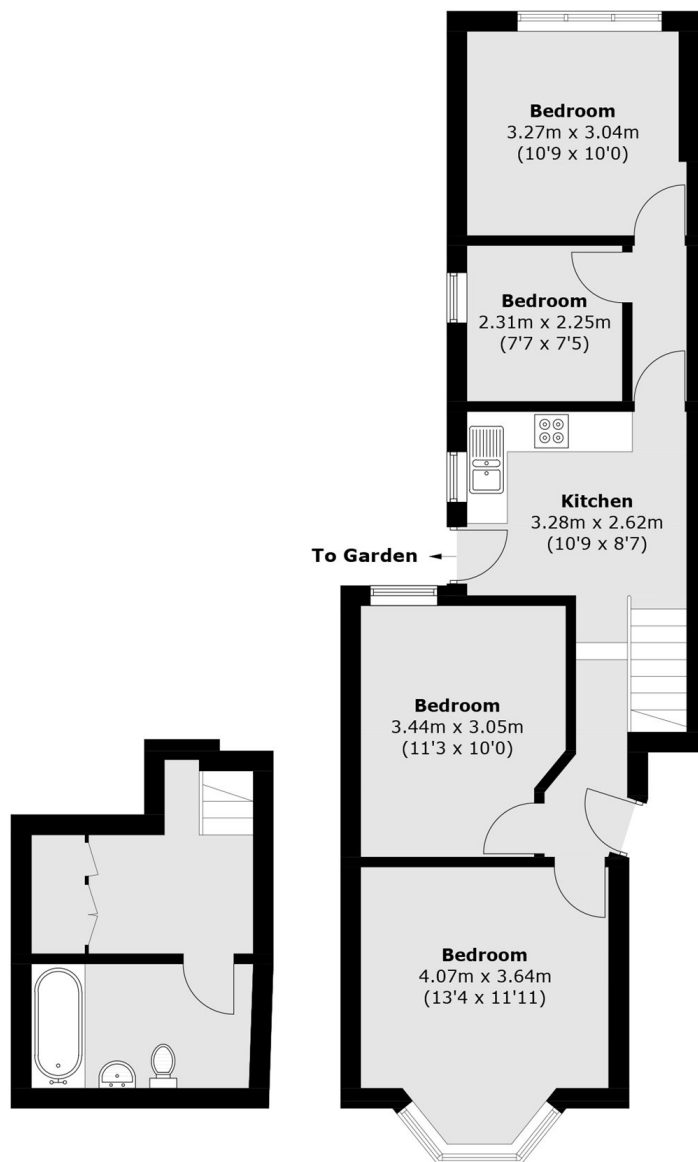

Lower Ground Floor

Ground Floor

Total area (approx.): 72.3 sq. m (778.3 sq. ft)