



**Hannington Road, SW4**  
**£700,000**

**Dexters**



## Hannington Road, SW4

Situated on a quiet, prestigious street in the heart of Clapham Old Town, this beautifully presented two-bedroom ground floor flat offers the perfect balance of modern living and period charm, complete with a private garden.

The property comprises two well-proportioned double bedrooms, a stylish contemporary bathroom, and a bright open-plan reception room with wooden flooring throughout. The fully integrated kitchen features sleek cabinetry and modern appliances, ideal for entertaining or everyday living. To the rear, French doors lead directly onto a private, low-maintenance garden perfect for al fresco dining, relaxing, or working from home in a tranquil setting.

Just a short walk from Clapham Common and excellent transport links, including the Northern Line and the Overground, this sought-after location offers a perfect blend of peaceful living and urban convenience. With local shops, cafés, schools, and green spaces all nearby, it's a popular choice for professionals, couples and families. It also benefits from being close to the popular nearby school, Belleville Wix Academy.

### Features

- Chain Free
- Two Double Bedrooms
- Ground Floor
- Open Plan Living / Dining
- Private Garden













# Hannington Road, London, SW4

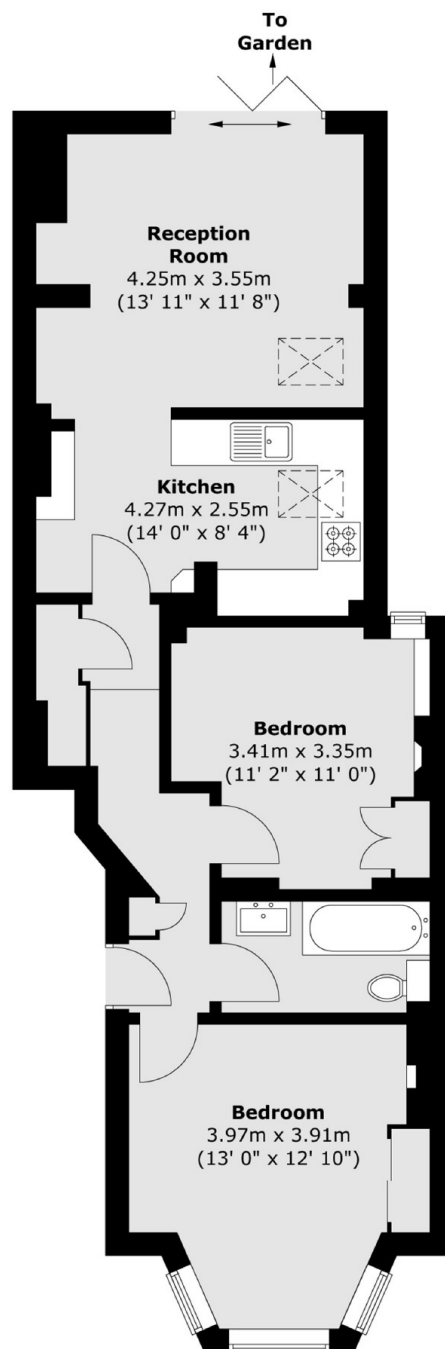

Total area (approx.) : 63.4 sq. m (682 sq. ft)

## Dexters

Clapham High Street  
55 Clapham High Street  
London  
SW4 7TG  
Sales  
020 7483 6363

Energy Rating: D. We aim to make our particulars both accurate and reliable. However they are not guaranteed; nor do they form part of an offer or contract. If you require clarification on any points then please contact us, especially if you're traveling some distance to view. Please note that appliances and heating systems have not been tested and therefore no warranties can be given as to their good working order.

 **RICS** | Regulated  
Estate Agent  
and Letting Agent

[dexters.co.uk](https://www.dexters.co.uk)