



Venn Street, SW4

£2,200 Per calendar month

This one double bedroom flat has wooden flooring throughout, a large kitchen, plenty of storage and a separate reception room leading to a private garden. Perfect for a professional couple.

Almost within touching distance of the Common and hosting the famous Saturday market, Venn Street has always been a firm favourite of young commuters.

Features

- One Double Bedroom
- Private Garden
- Prime Location
- Neutral Interior
- Wooden Flooring
- Separate Kitchen

Venn Street, London, SW4

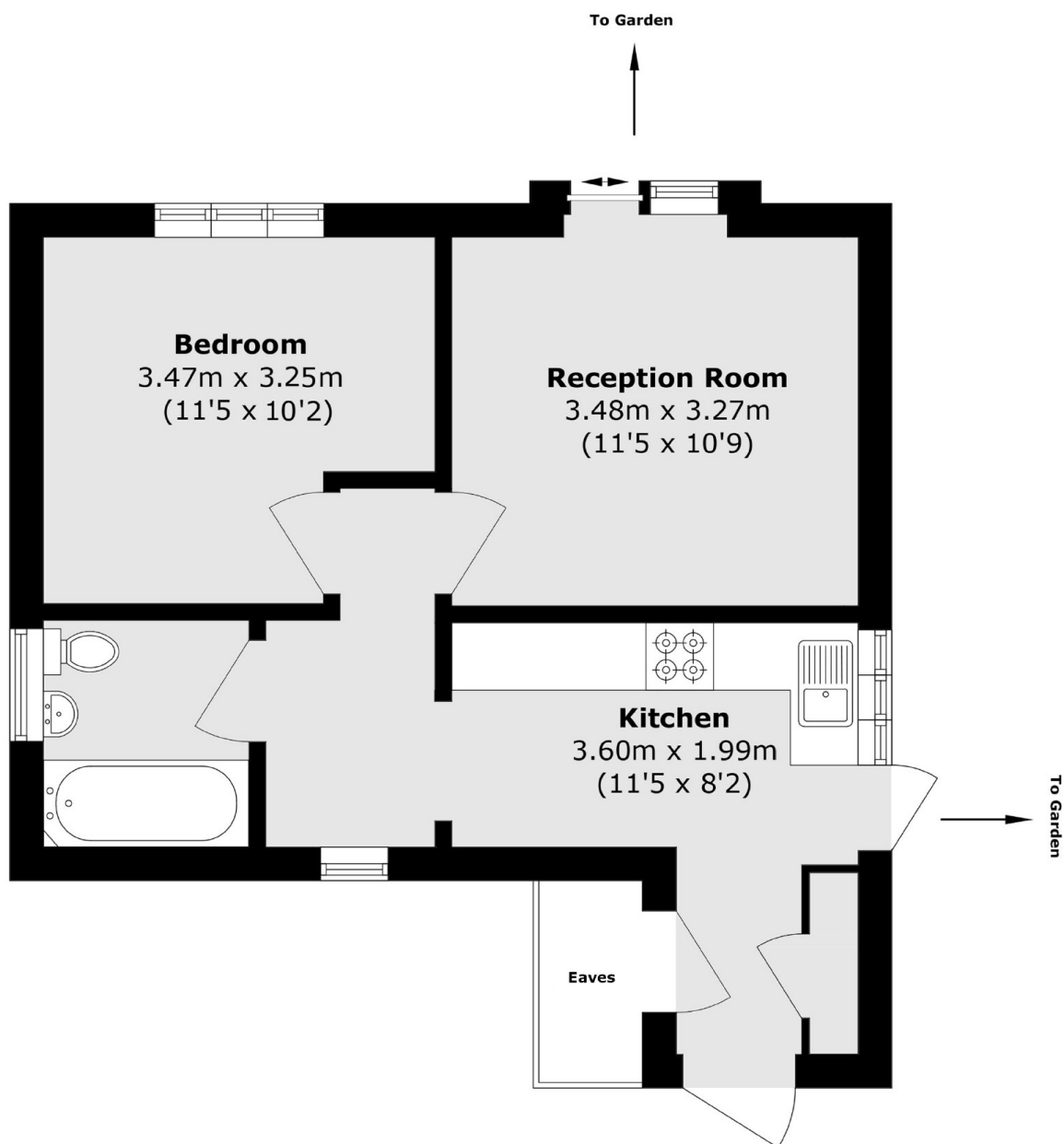

Total area (approx.): 42.3 sq. m (455.3 sq. ft)
(Excluding Eaves)