



Edgeley Road, SW4

£3,400 Per calendar month

This three double bedroom, ground floor flat has access to a private garden, large reception room with wooden flooring and a modern kitchen. Perfect for professional sharers.

In one of Clapham's most sought after mansion blocks, Elmhurst Mansions has easy access to Clapham High Street's bars, restaurants and pubs.

Features

- Three Double Bedrooms
- Prime Location
- Private Garden
- Wooden Flooring
- Ground Floor Flat
- Separate Reception

Edgeley Road, London, SW4

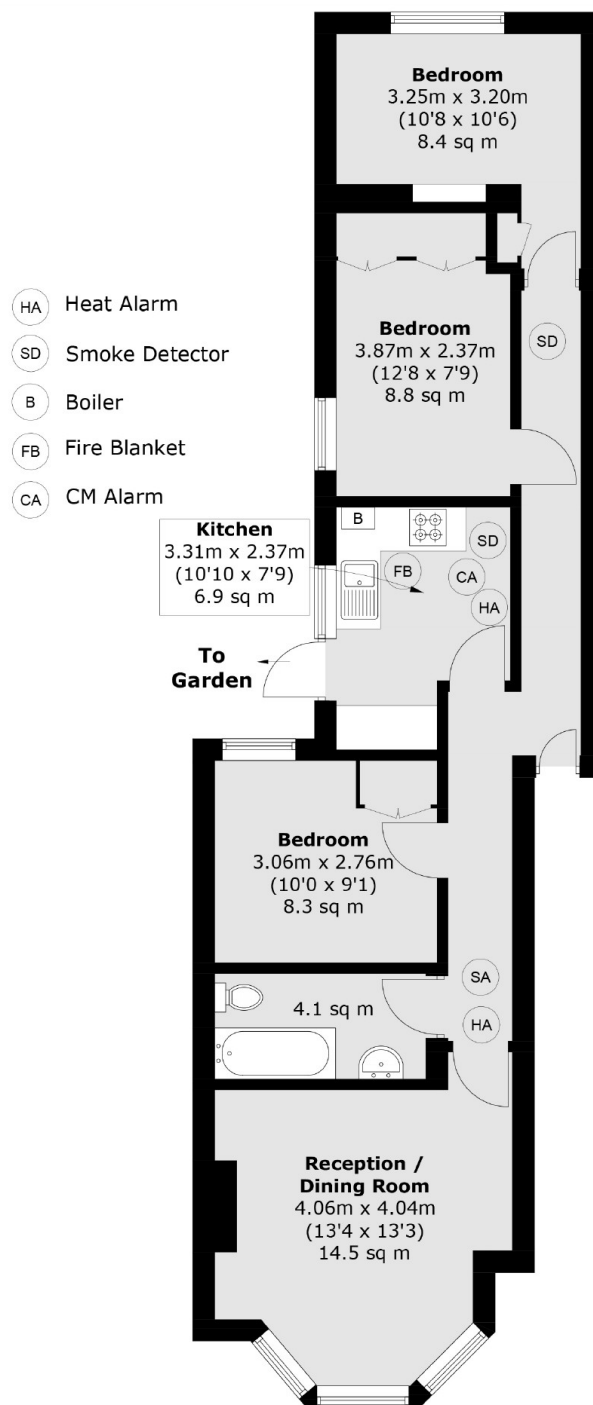

Total area (approx.): 65.6 sq. m (706.1 sq. ft)