



Sandmere Road, SW4

£3,250 Per week

A spacious, split level, ground floor and lower ground floor apartment. There are three double bedrooms and two bathrooms. An ideal property for three professional sharers. There is also access to a private but small decked garden.

Sandmere Road is a residential street within a short walk of Clapham High Street and Brixton. The transport links available within walking distance include the Northern and Victoria tube lines along with numerous bus routes.

Features

Ground And Basement
Neutral Throughout
Spacious
Wooden Floors
Large Windows
Two Bathrooms

Sandmere Road, London, SW4

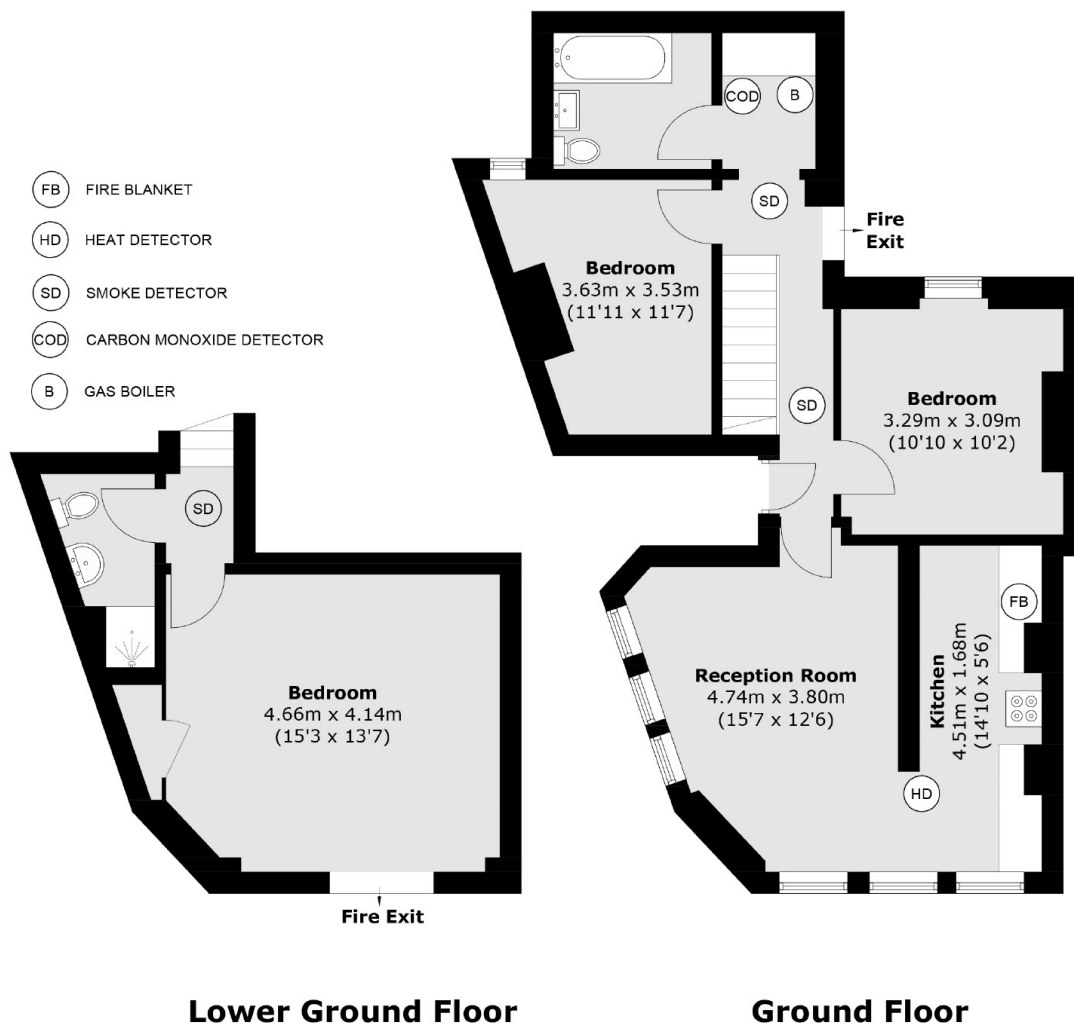

Total area (approx.): 82.2 sq. m (884.8 sq. ft)