



Stane Grove, SW9

£700,000

A phenomenal, contemporary apartment situated within a desirable gated development with allocated, underground parking. Extending to an inspiring 1,052 sq.ft the property provides a vast abundance of both living and entertaining space, comprising an open-plan reception room with a modern kitchen, two bedrooms and two bathrooms, both bedrooms are doubles, the first with an en suite and the second with a walk-in wardrobe. The development has recently undergone an extensive, £4,000,000 transformation, considerably upgrading the exterior aesthetic.

Stane Grove is situated a very short walk from Clapham High Street and Clapham Old Town which offer a broad range of shops, restaurants and bars. Clapham North Station (Northern Line) & Stockwell Station (Victoria Line) are both on your doorstep.

Features

- Modern Apartment
- Open-Plan Reception Room
- Integrated Kitchen
- Two Double Bedroom
- Two Bathrooms
- Underground Parking

Stane Grove, London, SW9

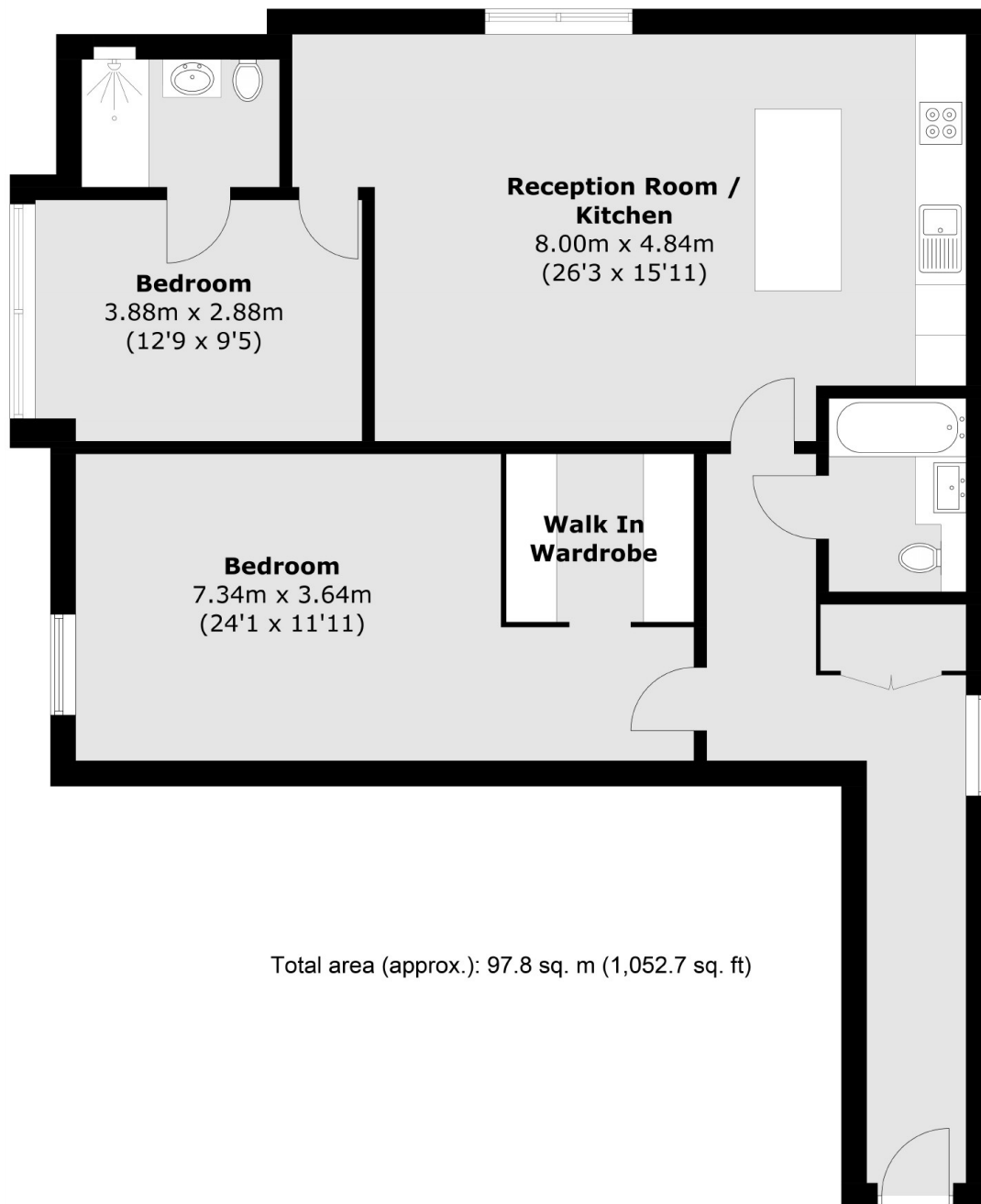

Dexters

Clapham High Street
55 Clapham High Street
London
SW4 7TG
Sales
020 7483 6364

Energy Rating: C. We aim to make our particulars both accurate and reliable. However they are not guaranteed; nor do they form part of an offer or contract. If you require clarification on any points then please contact us, especially if you're traveling some distance to view. Please note that appliances and heating systems have not been tested and therefore no warranties can be given as to their good working order.

 **RICS** | Regulated
Estate Agent
and Letting Agent

[dexters.co.uk](https://www.dexters.co.uk)