



New Park Road, SW2

£1,750 Per calendar month

A one double bedroom apartment in Brixton, set on the second floor of a modern development. The property comes with an open plan reception room with space for dining and a modern kitchen, along with a private balcony with views of the city.

Located on New Park Road which runs parallel to Brixton Hill, making access into Brixton Town Centre and Streatham Hill ideal. With a huge selection of shops, bars and restaurants.

Features

- One Double Bedroom
- Second Floor Flat
- Reception Room
- Modern Kitchen
- Secure Development
- Private Balcony

New Park Road, London, SW2

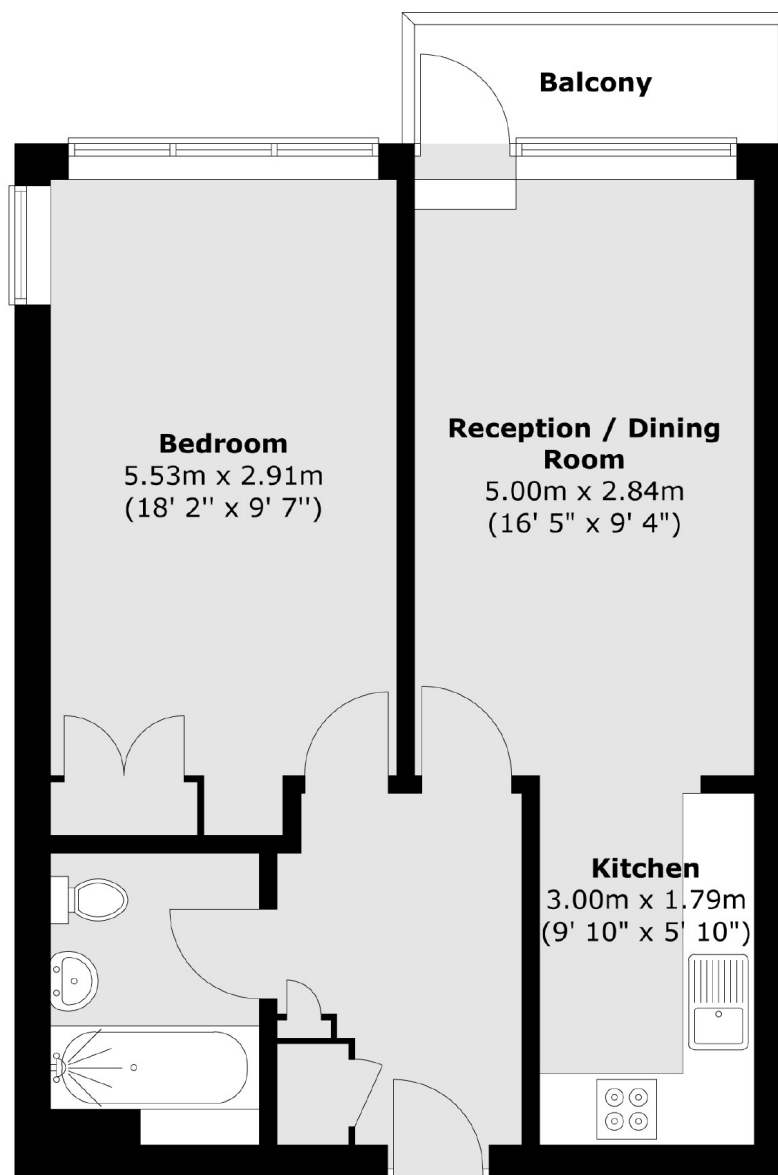

Total area (approx.) : 48.1 sq. m (518 sq. ft)
Total balcony area (approx.) : 2.8 sq. m (30 sq. ft)

Dexters

Clapham High Street
55 Clapham High Street
London
SW4 7TG
Lettings
020 7483 6363

Energy Rating: B. We aim to make our particulars both accurate and reliable. However they are not guaranteed; nor do they form part of an offer or contract. If you require clarification on any points then please contact us, especially if you're traveling some distance to view. Please note that appliances and heating systems have not been tested and therefore no warranties can be given as to their good working order.

 **RICS** | Regulated
Estate Agent
and Letting Agent

[dexters.co.uk](https://www.dexters.co.uk)