



Ballater Road, SW2

£853 Per week

Dexters



Ballater Road, SW2

Arranged over three floorings, this family home has been finished to a high standard throughout. Offering four double bedrooms, two bathrooms, a double reception room and separate eat-in kitchen.

A spacious four bedroom Victorian house perfect for a growing family or professional sharers.

The ground floor has a double reception room with bay windows, separate eat-in kitchen and access to a cellar. The property comes with a private patio garden with access from both kitchen and reception room.

The first and second floors offer four double bedrooms, a three piece bathroom suite and shower room.

Neutrally decorated and complete with wooden flooring throughout, this house is the ideal for renters.

Located just off Acre Lane, which is on the door step of vibrant Brixton and trendy Clapham. Brixton provides excellent transport links into the City.

Features

- Four Double Bedrooms
- Double Reception Room
- Eat-In Kitchen
- Wooden Flooring
- Two Bathrooms
- Large Patio Garden







Ballater Road, London, SW2

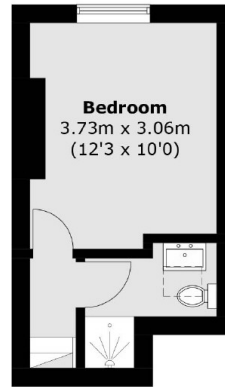

Second Floor



**Lower
Ground Floor**

Ground Floor

First Floor

Total area (approx.): 126.7 sq. m (1,363.8 sq. ft)