



Grafton Square, SW4

£2,000 Per calendar month

A second floor, one bedroom flat in Grafton Square. Recently refurbished and offering an open plan reception room and kitchen, one double bedroom, bathroom and neutral interior throughout.

Situated in one of the most desirable residential squares in South West London. With access to many boutique shops, restaurants, bars and Clapham Common tube.

Features

- One Double Bedroom
- Second Floor Flat
- Open Plan Reception
- Recently Refurbished
- Neutral Interior
- Prime Location

Grafton Square, London, SW4

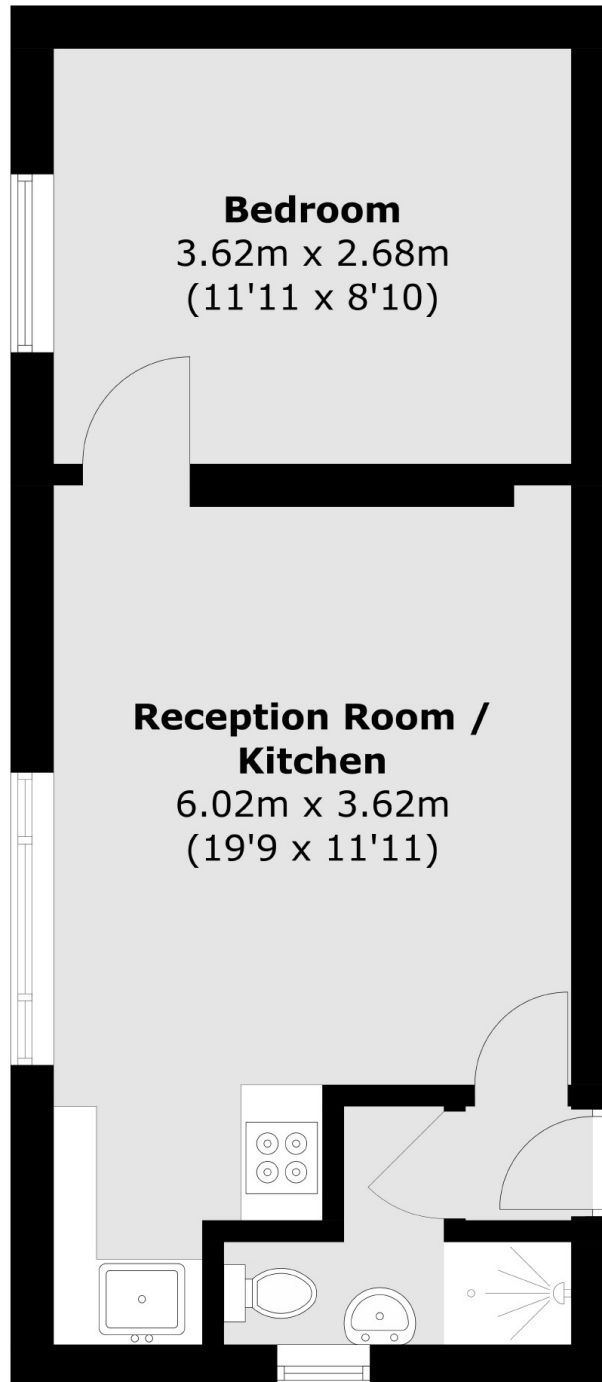

Total area (approx.): 33.0 sq. m (355.2 sq. ft)

Dexters

Clapham High Street
55 Clapham High Street
London
SW4 7TG
Lettings
020 7483 6364

Energy Rating: C. We aim to make our particulars both accurate and reliable. However they are not guaranteed; nor do they form part of an offer or contract. If you require clarification on any points then please contact us, especially if you're traveling some distance to view. Please note that appliances and heating systems have not been tested and therefore no warranties can be given as to their good working order.

 **RICS** | Regulated
Estate Agent
and Letting Agent

dexters.co.uk