



Stane Grove, SW9

£2,350 Per week

A stylish two double bedroom flat within a private gated development. Offering a spacious open plan reception with kitchen, built-in wardrobes, wooden flooring throughout and a Juliet balcony with access to locked bike storage.

Located less than half a miles walk from both Clapham North and Stockwell tube stations, with local amenities that include a local Sainsbury's.

Features

- Two Double Bedrooms
- Open Plan Reception
- Wooden Flooring
- Juliet Balcony
- Underground Parking
- Private Gated Development

Stane Grove,
London, SW9

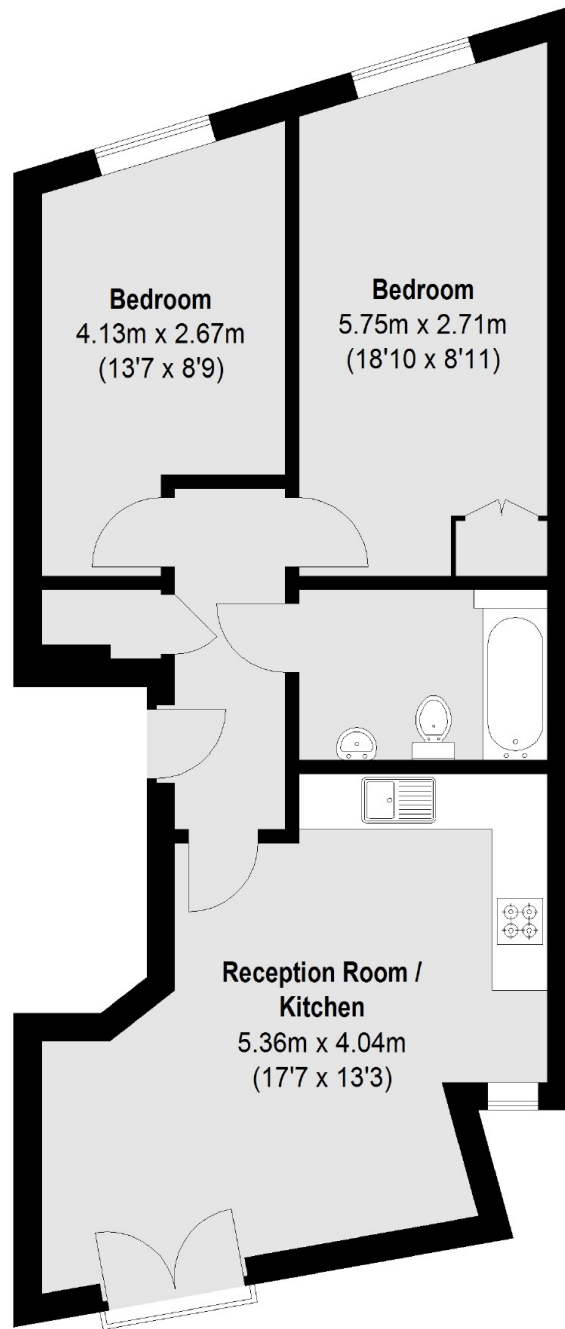

Second Floor

Total area (approx.): 60.9 sq. m (656 Sq. ft)