



Blenheim Gardens, SW2

£3,500 Per calendar month

A four bedroom house, split over two levels. Offering a spacious open plan reception room, eat in kitchen with a breakfast bar, wooden flooring, two bathrooms and a private patio garden.

Located within walking distance of Brixton centre which offers the Ritzy Cinema, shops, bars and restaurants. Also the Victoria Line and surface rail station.

Features

- Four Double Bedrooms
- Open Plan Reception
- Eat In Kitchen
- Wooden Flooring
- Two Bathrooms
- Private Patio Garden

Blenheim Gardens, London, SW2

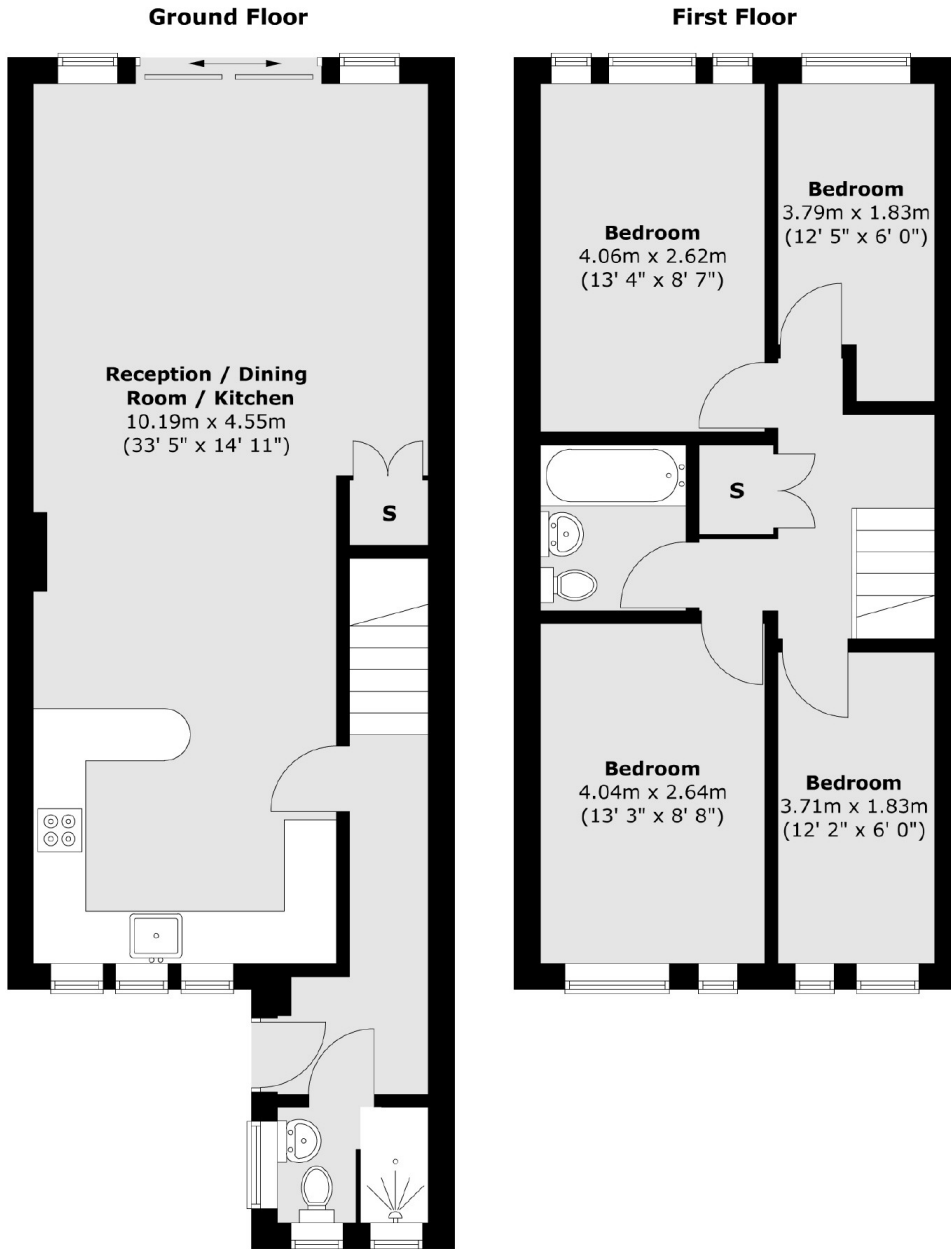

Total area (approx.) : 100.3 sq. m (1079 sq. ft)