



Point Pleasant, SW18
£2,200,000

Waterview

A beautiful split level penthouse with some of the best views of The Thames in London, from the impressive principal living room with curved panoramic window to the balconies and roof terrace.

Prospect Quay is located by The Thames next to Wandsworth Park with a wide selection of shops and restaurants nearby.





Accommodation is made up of entrance hallway leading to a stunning circular reception room with 180 degree views of the river and The Hurlingham Club opposite with private balcony.

The spacious principal suite has access to a further balcony with a range of built-in wardrobes and a luxury four piece en-suite. There is a further second double bedroom with en-suite, third bedroom and family bathroom on this level. A grand sweeping staircase leads from the main reception room to the first floor with a stylish open plan kitchen and dining space that enjoys the same panoramic aspect of the river. From the kitchen there is access to a secluded terrace/entertaining area. A feature spiral staircase takes you to a large roof terrace giving 360 degree views of the river and London beyond. This exclusive, private development has a private gym and good sized pool. The apartment has two parking spaces.

Features

Beautiful Penthouse
2,264 sq ft
Panoramic Views
Roof Terrace
Split Level
Gated Development



Point Pleasant, Wandsworth, SW18

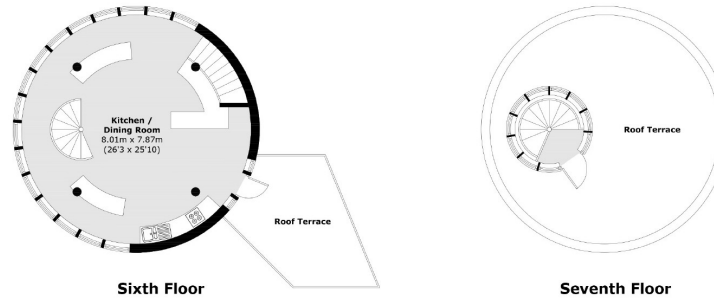

Fifth Floor

Total area (approx.): 210.4 sq. m (2,264.7 sq. ft)
Balcony / Roof Terrace (approx.): 73.6 sq. m (792.2 sq. ft)

Contact

To arrange a viewing call our office on the number below or visit our website.



Energy Rating: C. We aim to make our particulars both accurate and reliable. However they are not guaranteed; nor do they form part of an offer or contract. If you require clarification on any points then please contact us, especially if you're traveling some distance to view. Please note that appliances and heating systems have not been tested and therefore no warranties can be given as to their good working order.

