



Pharaohs Island, TW17  
£825,000

Waterview  



A rare opportunity to purchase this unique house and gardens on the head of this private island on The Thames at Shepperton. Enjoying unrivalled river views and approx 130 metres of river frontage, there is approved planning for a beautiful modern house.

Pharaohs Island is a stunning private island on The Thames at Shepperton accessed by boat.







The property is approached via boat access at The Towpath Shepperton. The current house is single storey and comprises of five reception rooms, kitchen, utility room, two bedrooms and two bathrooms.

The gardens measure 0.4 of an acre with large lawned areas and mature trees and shrubs. With 130 meters of river frontage there are mooring options for several boats. There is current approved planning for a beautiful contemporary house.

### Features

- Island House
- 130 Meter Frontage
- Fantastic Views
- Planning Approved
- Extensive Gardens
- Unique Opportunity







# Pharaohs Island, Shepperton, TW17

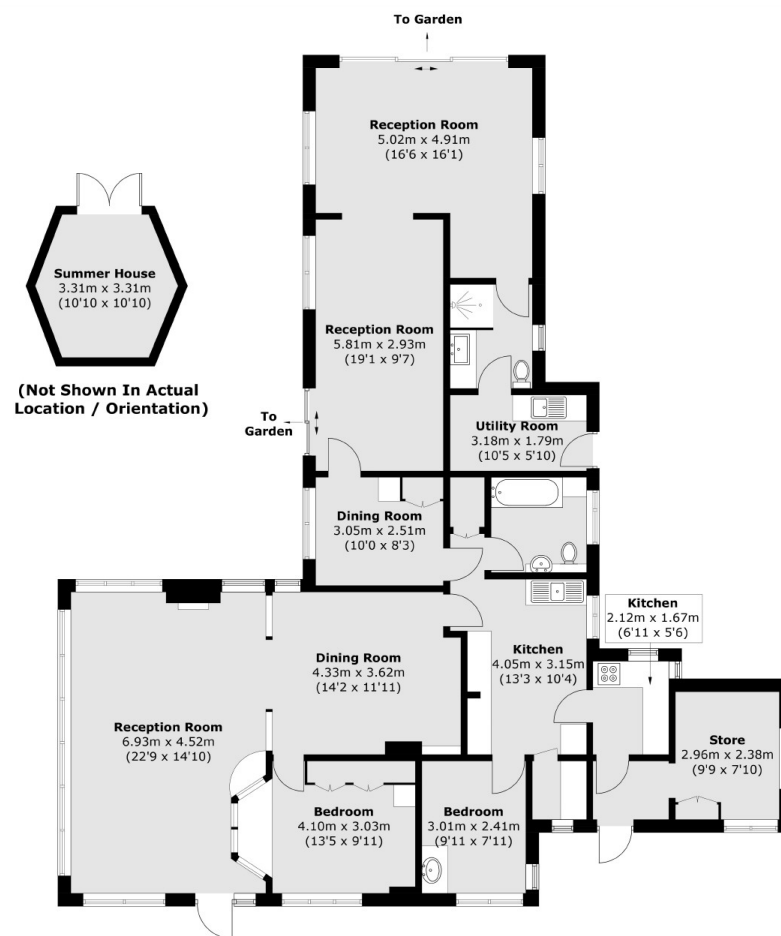

Total area (approx.): 162.0 sq. m (1743.7 sq. ft)  
Summer House area (approx.): 8.7 sq. m (93.6 sq. ft)

## Contact

To arrange a viewing call our office on the number below or visit our website.



Energy Rating: E. We aim to make our particulars both accurate and reliable. However they are not guaranteed; nor do they form part of an offer or contract. If you require clarification on any points then please contact us, especially if you're traveling some distance to view. Please note that appliances and heating systems have not been tested and therefore no warranties can be given as to their good working order.



