



Hamhaugh Island, TW17
£995,000

Waterview

A beautiful, modern built chalet bungalow on this sizeable plot. Situated on this private island and backing onto The Thames with lovely river views and 60ft of private moorings.

Hamhaugh Island is an idyllic private island accessed by foot bridge over the lock at Shepperton.





Accommodation is made up of entrance hall, leading to an impressive 28' open plan living area with space for dining, full width bi-fold doors to the garden and river views with a stylish modern kitchen. There is a double bedroom, single bedroom and family bathroom. On the first floor is a large double bedroom with en-suite and lots of eaves storage.

To the riverside is a large decked entertaining area overlooking the pretty lawned west facing garden and river views with steps to a 60ft private mooring. To the non-riverside there is a large lawned garden with a modern guest annexe, incorporating a double bedroom and en-suite bathroom.

Features

Modern House
Large Plot
West Facing
60ft mooring
Private island
Annexe



Hamhaugh Island, Shepperton, TW17

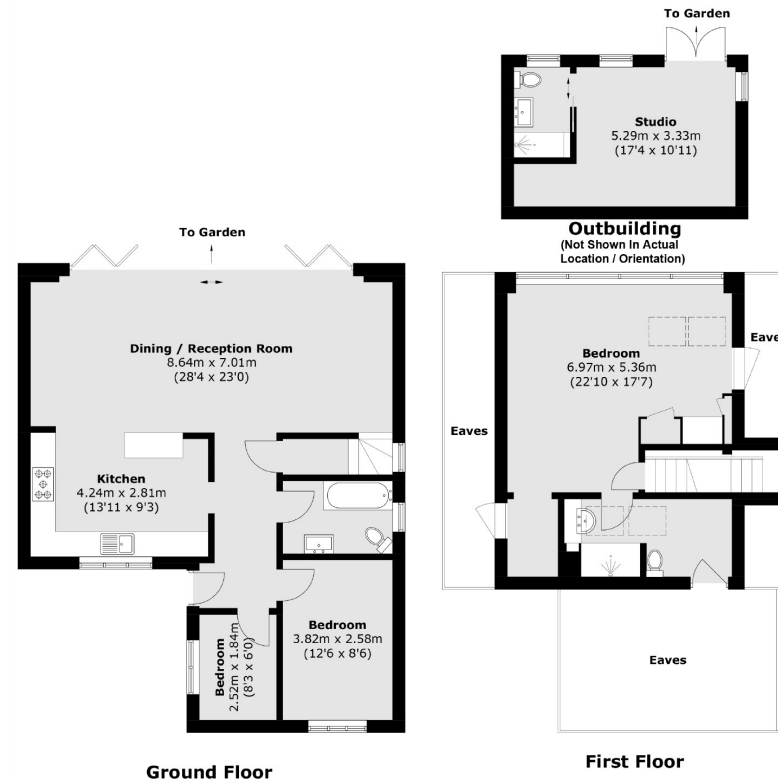

Total area (approx.): 115.8 sq. m (1,246.5 sq. ft)
Outbuilding area (approx.): 17.8 sq. m (191.6 sq. ft)
(Excluding Eaves)

Contact

To arrange a viewing call our office on the number below or visit our website.



Energy Rating: . We aim to make our particulars both accurate and reliable. However they are not guaranteed; nor do they form part of an offer or contract. If you require clarification on any points then please contact us, especially if you're traveling some distance to view. Please note that appliances and heating systems have not been tested and therefore no warranties can be given as to their good working order.

