



The Creek, TW16
£685,000

Waterview

A charming detached three bedroom bungalow set overlooking this picturesque backwater of The Thames with pretty garden and private mooring.

The Creek is a quiet cul-de-sac road located off Fordbridge Road next to the village of Sunbury-upon-Thames.





Accommodation is made up of a double reception room with dining area which in turn leads into a conservatory overlooking the garden and river. There is a country style kitchen with separate utility room. Two generous double bedrooms have en-suite and shower rooms with a third single bedroom and family bathroom. To the front the driveway has parking for several cars and there is a large detached double garage. To the riverside the pretty south east facing garden leads to a 35ft private mooring. The house sale is subject to probate and offered with no onward chain.

Features

Charming House
Three Bedrooms
Three bathrooms
35ft Mooring
No Chain
Large Double Garage



The Creek, Sunbury-On-Thames, TW16

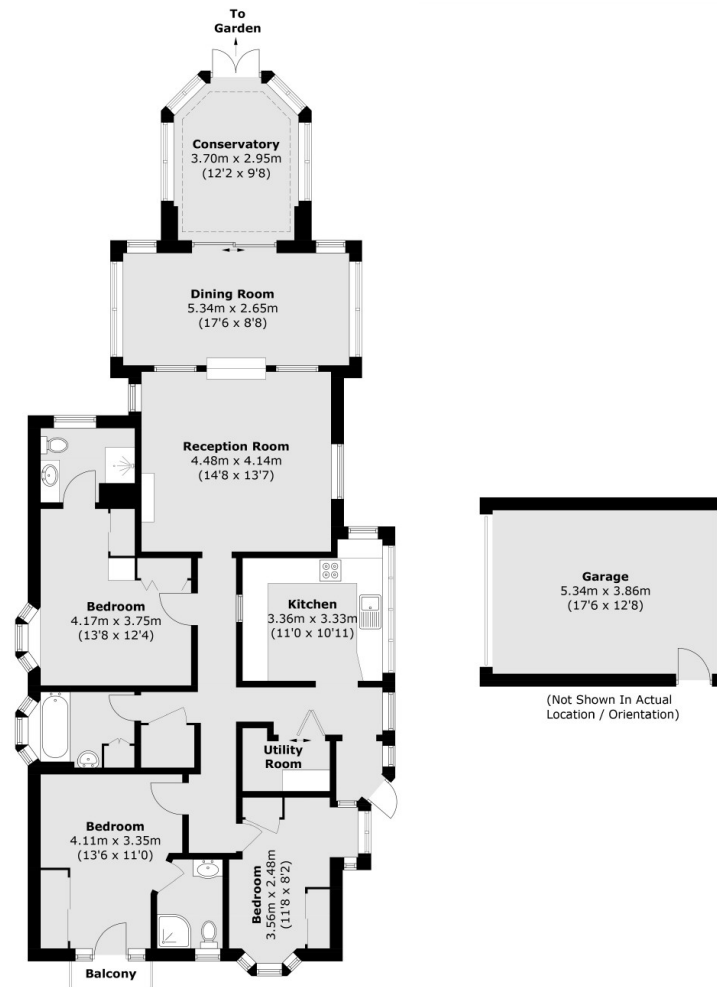

Total area (approx.): 125.0 sq. m (1,345.5 sq. ft)

Garage : 20.7 sq. m (222.8 sq. ft)

Balcony area (approx.): 1.2 sq. m (12.9 sq. ft)

Contact

To arrange a viewing call our office on the number below or visit our website.



Energy Rating: E. We aim to make our particulars both accurate and reliable. However they are not guaranteed; nor do they form part of an offer or contract. If you require clarification on any points then please contact us, especially if you're traveling some distance to view. Please note that appliances and heating systems have not been tested and therefore no warranties can be given as to their good working order.

