



The Hythe, TW18
£465,000

Waterview

A beautiful, historic riverside cottage that has been sensitively refurbished with stylish interiors offering fantastic views of The Thames.

The Hythe is a peaceful spot close to a fantastic pub and river walks, with Staines town centre a short walk over the bridge.





Accommodation is made up of a modern integrated kitchen, open plan onto a family dining area with newly fitted oak flooring throughout. At it's centre is an open plan living space that makes full use of the home's period proportions. The spacious, bright living area has a log burner and sliding doors to the riverside garden. There is a further reception space/reading room off the living room.

Upstairs the large principal bedroom has access to a wrap around terrace offering ample room for a cozy seating area, perfect for enjoying a morning coffee or evening relaxation which overlooks the river. There is a second double bedroom and a family bathroom on this floor. Externally the versatile garage has been transformed into a stylish office/studio, perfect for office work/additional storage.

To the rear of the cottage a raised patio garden also overlooks this picturesque river view with access to the towpath.

Features

- Beautiful Cottage
- Stylish Interiors
- River Terrace
- Work Space
- Great Views
- Central Location



The Hythe, Staines-Upon-Thames, TW18

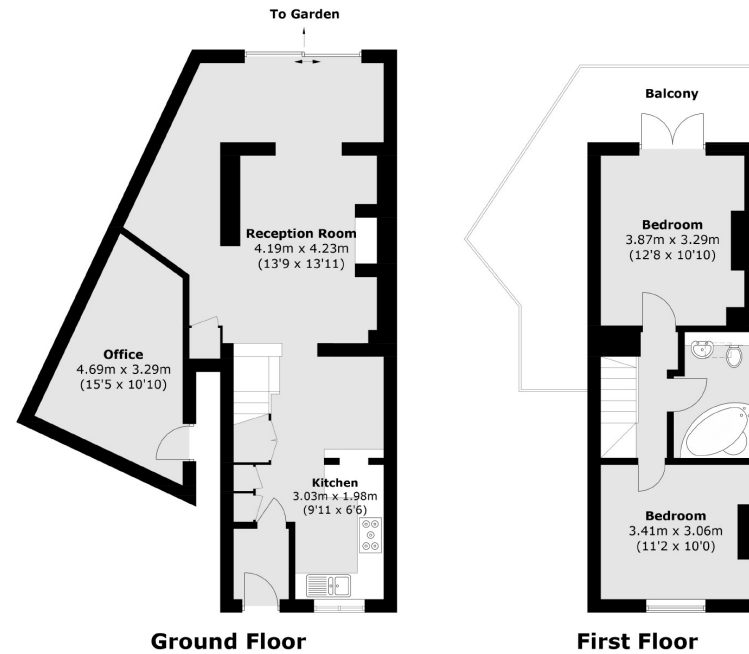

Total area (approx.): 85.5 sq. m (920.2 sq. ft)
External Office: 11.9 sq. m (128.0 sq. ft)
Balcony: 18.3 sq. m (196.9 sq. ft)

Contact

To arrange a viewing call our office on the number below or visit our website.



Energy Rating: D. We aim to make our particulars both accurate and reliable. However they are not guaranteed; nor do they form part of an offer or contract. If you require clarification on any points then please contact us, especially if you're traveling some distance to view. Please note that appliances and heating systems have not been tested and therefore no warranties can be given as to their good working order.

