



Station Court, SW6

£496 Per week

A well presented two double bedroom apartment located on the seventh floor of a modern purpose built development which is ideally located for Imperial Wharf station and the New Kings Road.

The property is ideally positioned for the wide range of shops and boutiques on the New King's Road, Imperial Wharf and Fulham Broadway are the closest stations.

Features

- Two Double Bedrooms
- Modern Bathroom
- Open Plan Reception
- Available May
- Lift
- 24 Hour Concierge

Station Court, London, SW6

Seventh Floor

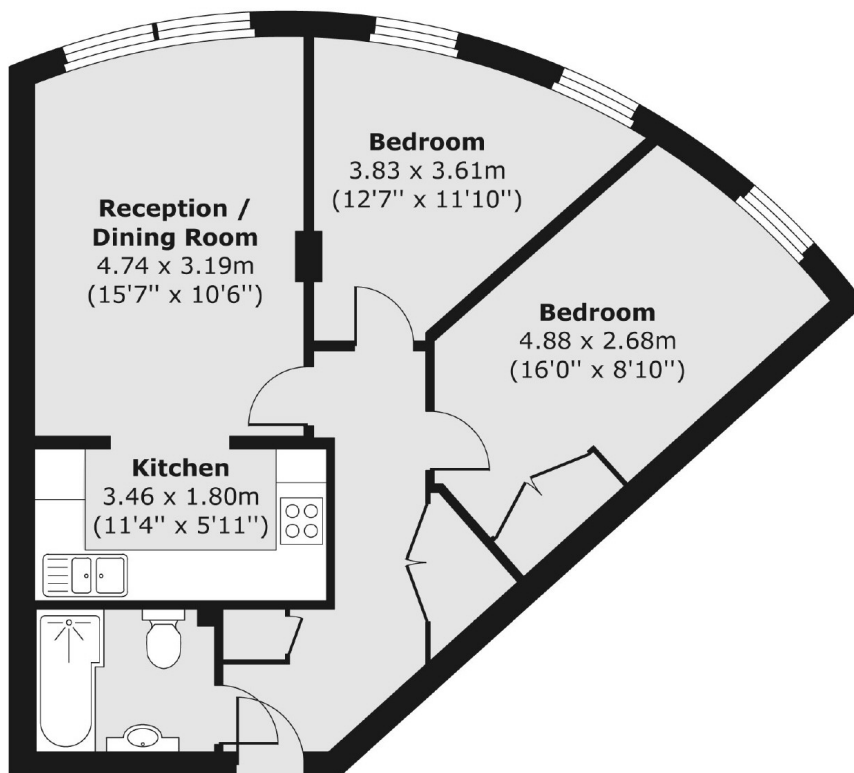

Total area (approx.) 57.24 sq. m (616 sq. ft)