



## Ham Island, SL4

£450,000

### Cash Buyers Only

A rare opportunity to purchase this timber built two bedroom home on the river, ideal as a plot to build, on this private island with a plot of land opposite for parking.

Ham Island is located off Straight Road close to the historic town of Windsor.

### Features

River Home  
Build Plot  
40ft Frontage  
Private Island  
Parking  
Garage

## Ham Island, Windsor, SL4

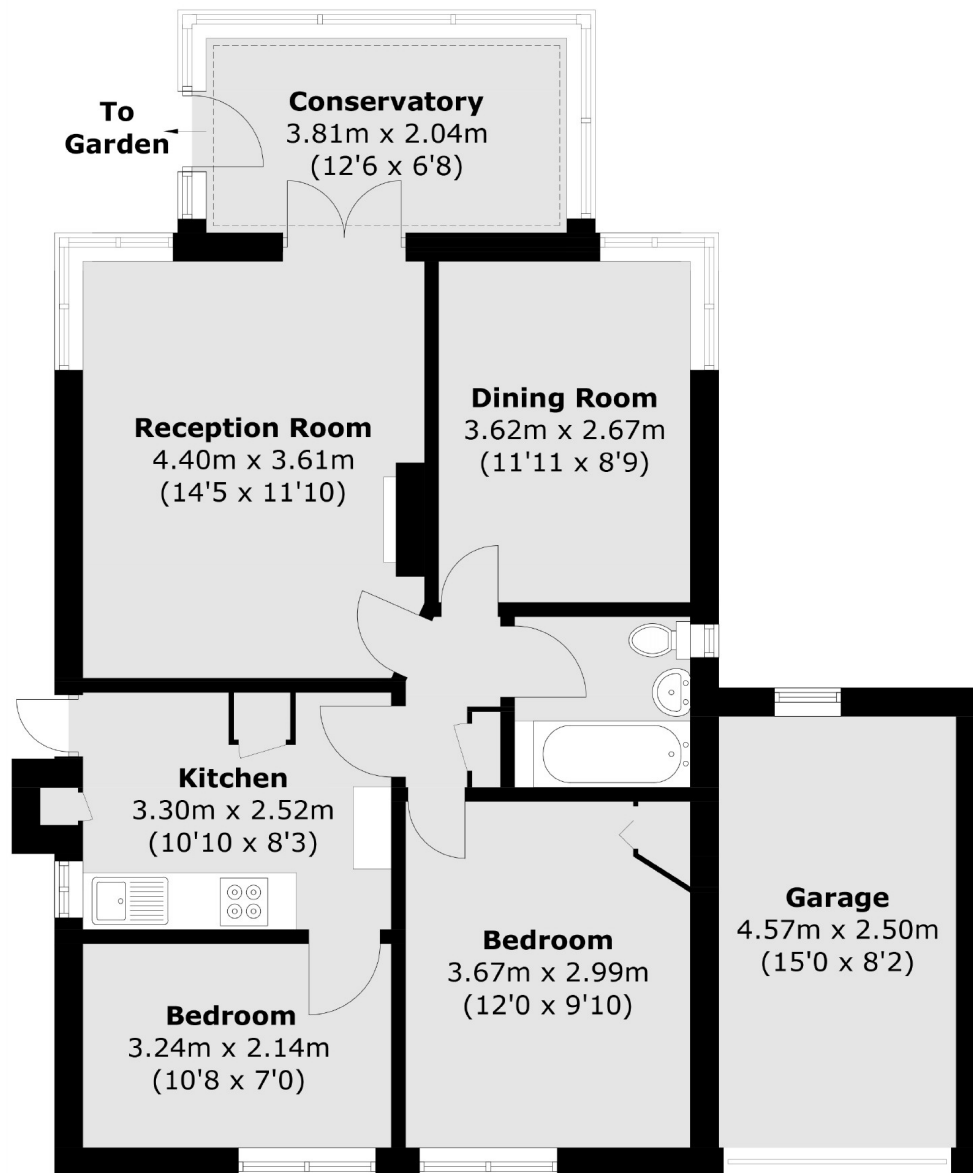

Total area (approx.): 69.2 sq. m (744.9 sq. ft)  
Garage : 11.4 sq. m (122.7 sq. ft)

### Contact

To arrange a viewing call our office on the number below or visit our website.



Energy Rating: G. We aim to make our particulars both accurate and reliable. However they are not guaranteed; nor do they form part of an offer or contract. If you require clarification on any points then please contact us, especially if you're traveling some distance to view. Please note that appliances and heating systems have not been tested and therefore no warranties can be given as to their good working order.